



Active since July 1, 2019, Deco Swiss Tech aims to provide spare parts for the following Tornos machines:

<b>ENC</b>	<b>DECO</b>	<b>MICRO</b>	<b>EVODECO</b>
------------	-------------	--------------	----------------

Our clients operate in various fields:

<b>Medical</b>	<b>Connectors</b>	<b>Dental</b>
<b>Equipment</b>	<b>Watchmaking</b>	<b>Automobile</b>

We also offer a service for the purchase and resale of used machines.  
We are happy to share our experience and expertise for all other requests such as:

<b>Maintenance Training</b>	<b>Programming Troubleshooting</b>
<b>Part Identification</b>	<b>Equipment and Tool Suggestion</b>



## COUPLINGS



**MK5 14/12 mm**

13647



**MKJ-90 12/19**

13030



**K17 6/6**

12762



**6/6 mm**

13167

**MKJ-130 25/25**

13644

**K17 6/10**

12763

**6/8 mm**

13908

## BATTERY



**CR17450SE  
Double (6V)**

13351



**BR-CCF2TH  
(BR2-3) (6 V)**

13324



**4panbr2-3ak  
(6V)**

12865



**CR17450SE-R  
(3V)**

13334



**CR17335  
SE (3V)**

12866



**1,5 V  
Mono**

13265

# FAN

	60 x 60 x 25	<b>14158</b>
	92 x 92 x 25	<b>13231</b>
	40 x 40 x 15	<b>13249</b>
	60 x 60 x 15	<b>13252</b>
	60 x 60 x 15	<b>14982</b>
	40 x 40 x 20	<b>14982</b>
	40 x 40 x 20	<b>12780</b>
	80 x 80 x 38	<b>14157</b>
	80 x 80 x 38	<b>14981</b>
	119 x 119	<b>13290</b>





<b>X1</b>	13460	13093	13006	12998	390 mm	ON DEMAND	ON DEMAND
<b>Z1</b>	12870	13093	13006	12991	455 mm	ON DEMAND	ON DEMAND
<b>X2</b>	13448	13093	12968	12869	530 mm	ON DEMAND	ON DEMAND
<b>Z2</b>	13431	2 x 13148	13021	13644	Acc	ON DEMAND	13117
<b>S1</b>	-	-	-	13114	840 mm	ON DEMAND	-
<b>S2</b>	-	-	-	13007 + 13077	480 mm + 575 mm	ON DEMAND	-
<b>COD S1</b>	-	-	-	13167	Acc	ON DEMAND	-
<b>THK</b>	-	13117	-	-	-	ON DEMAND	-
<b>S1 à ENT</b>	-	-	-	14140	455 mm	ON DEMAND	-
<b>Ent à canon</b>	-	-	-	14139	410 mm	ON DEMAND	-

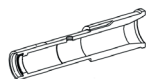

**S1 / S2** F13 = 15216

**S1 / S2** F20 = 13440



**MOTOR**



**MOTOR FAN**

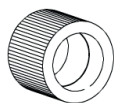

**MOTOR PULLEY**



**CODER CABLE**



**AMPLIFIER**



**AMPLIFIER FAN**

	MOTOR	MOTOR FAN	MOTOR PULLEY	CODER CABLE	POWER CABLE	AMPLIFIER	AMPLIFIER FAN		
<b>X1</b> <b>Série 1</b>	ON DEMAND	M101	-	ON DEMAND	13289	13330	13288	AD3	-
<b>X1</b> <b>dès</b> <b>série 2</b>	14273	M101	-	ON DEMAND	13289	13330	14291	AD3	-
<b>X2</b> <b>Série 1</b>	13287	M103	-	ON DEMAND	13289	13270 14069		AD5	-
<b>X2</b> <b>Dès</b> <b>Série 2</b>	13287	M103	-	ON DEMAND	13289	14069		AD5	-
<b>Z1</b> <b>Série 1</b>	13286	M102	-	ON DEMAND	13289	13330	13288	AD3	-
<b>Z1</b> <b>dès</b> <b>série 2</b>	13286	M102	-	ON DEMAND	13289	13330	14291	AD3	-
<b>Z2</b>	13283	M104	-	ON DEMAND	13289	13330	13284	AD4	-
<b>S1</b>	14719	M113		ON DEMAND			14314	AD2	-
<b>S2</b>	14250	M114		ON DEMAND				AD5	-
	13291	M11	-		13294	13293	13323	AD11	-
	13291	M12	-		13294	13293	13323	AD12	-
	13291	M13	-		13294	13293	13323	AD13	-
	13291	M14	-		13294	13293	13323	AD14	-





<b>X1</b>	14068 (S1) 13453 (S2-6)	14134	13021	13050	690 mm	ON DEMAND	ON DEMAND
<b>Y1</b>	13452	13150 (S1-6) 13162 (S6)	13018	14133	Acc	ON DEMAND	ON DEMAND
<b>Z1</b>	12870	13093	13006	12991	455 mm	ON DEMAND	ON DEMAND
<b>X2</b>	13448	13093	12968	13060	440 mm	ON DEMAND	ON DEMAND
<b>Z2</b>	13431	2 x 13148	13021	13644	Acc	ON DEMAND	13117
<b>S1</b>	-	-	-	13114	840 mm	ON DEMAND	-
<b>ENT CANON</b>	13117	-	-	-	-	ON DEMAND	-
<b>S2 à THK</b>	-	-	-	2 x 12989	500 mm	ON DEMAND	-
<b>S2 à ctr-br</b>	-	-	-	13007	480 mm	ON DEMAND	-
<b>Codeur</b>	-	-	-	13167	Acc	ON DEMAND	-
<b>S1 à ENT</b>	-	-	-	14140	455 mm	ON DEMAND	-
<b>Ent à canon</b>	-	-	-	14139	410 mm	ON DEMAND	-
<b>T11</b>	-	-	-	13049	390 mm	ON DEMAND	-
<b>T12</b>	-	-	-	13049	390 mm	ON DEMAND	-
<b>T11+T12</b>	-	-	-	13078	420 mm	ON DEMAND	-
<b>T11 **</b>	-	-	-	13070	455 mm	ON DEMAND	-
<b>T12 **</b>	-	-	-	13070	455 mm	ON DEMAND	-
<b>T13 **</b>	-	-	-	12989	500 mm	ON DEMAND	-

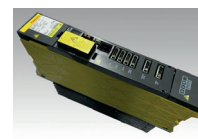
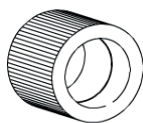

**MOTOR**

**MOTOR FAN**

**MOTOR PULLEY**

**CODER CABLE**

**POWER CABLE**

**AMPLIFIER**

**AMPLIFIER FAN**

<b>X1</b>	13318	M101	-	ON DEMAND	14160	13330	15395	AD4	13252
<b>Y1</b>	13319	M105	-	ON DEMAND	14160	13330	15395	AD4	13252
<b>X2</b>	13307	M103	-	ON DEMAND	13268	13270	15068	AD3	13252
<b>Z2</b>	13317	M104	-	ON DEMAND	14160	13330	15068	AD3	13252
<b>Z1</b>	13319	M102	-	ON DEMAND	14160	13330	15395	AD4	13252
<b>S1</b>	13320	M113		ON DEMAND	13480		13311	AD1	13243
<b>S2</b>	14136	M114		ON DEMAND	13481		15331	AD2	13243
	13322	M11	-	ON DEMAND	13294	13293	13323	AD11	-
	13291	M12	-	ON DEMAND	13294	13293	13323	AD12	-
	13291	M13	-	ON DEMAND	13294	13293	13323	AD13	-
	13291	M14	-	ON DEMAND	13294	13293	13323	AD14	-
<b>ALIM 1</b>	-	-	-	ON DEMAND	-	-	14232	AD0	13252

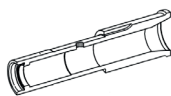
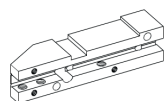
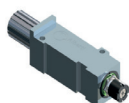

### Axial 15 mm

<b>X1/Y1</b>	15124	15281	
<b>X3/Z3 (S3)</b>	-	-	
<b>S1/ S2</b>	-	-	F13 = 15216
<b>S1/ S2</b>			F20 = 13440





<b>Z1</b>	13422	12995 + 12996	13018 + 13021	13030	Acc	ON DEMAND	13033 13034
<b>X2</b>	13061	13063	13018	12989	500 mm	ON DEMAND	13029 13052
<b>Z2</b>	13431	13064	13021	13644	Acc	ON DEMAND	13058 13059
<b>M24/M25</b>	-	-	-	-	-	-	13001 13002
<b>S1</b>	-	-	-	13047	780 mm	ON DEMAND	-
<b>S2 2:1</b>	-	-	-	13050 (L=14)	690 mm	ON DEMAND	-
<b>S2 2:1</b>	-	-	-	13101 (L=16)	690 mm	ON DEMAND	-
<b>S2 1:1</b>	-	-	-	13646	590 mm	ON DEMAND	-
<b>Codeur S2</b>	-	-	-	12976	390 mm	ON DEMAND	-
<b>T11 1:1</b>	-	-	-	13078	420 mm	ON DEMAND	-
<b>T11 2:1</b>	-	-	-	12989	500 mm	ON DEMAND	-
<b>T12 1:1</b>	-	-	-	13049	390 mm	ON DEMAND	-
<b>T12 2:1</b>	-	-	-	13070	455 mm	ON DEMAND	-
<b>T13</b>	-	-	-	12989	500 mm	ON DEMAND	-
<b>T11-T12</b>	-	-	-	13645	295 mm	ON DEMAND	-
<b>T11-T13</b>	-	-	-	13070	455 mm	ON DEMAND	-
<b>T12-T13</b>	-	-	-	13645	295 mm	ON DEMAND	-



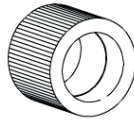

**MOTOR**

**MOTOR FAN**

**MOTOR PULLEY**

**CODER CABLE**

**POWER CABLE**

**AMPLIFIER**

**AMPLIFIER FAN**

<b>X1 S. 1-13</b>	ON DEMAND	M101	-	ON DEMAND	13268	13270	14194	AD3	-
<b>X1 DES S.14</b>	ON DEMAND	M101	-	ON DEMAND	13268	13270	13284	AD3	-
<b>X2 S. 1-13</b>	13260	M103	-	ON DEMAND	13268	13270 14069	14194	AD4	-
<b>X2 DES S.14</b>	13260	M103	-	ON DEMAND	13268	13270 14069	13284	AD4	-
<b>Z2 S. 1-13</b>	13267	M104	-	ON DEMAND	13289	13269	13463	AD5	-
<b>Z2 DES S.14</b>	13283	M104	-	ON DEMAND	1729	13330	14191	AD5	-
<b>Z1 S. 1-13</b>	13260	M102	-	ON DEMAND	13268	13270	14194	AD3	-
<b>Z1 DES S.14</b>	13260	M102	-	ON DEMAND	13268	13270	13284	AD3	-
<b>S1</b>	ON DEMAND	M113	12802	ON DEMAND	ON DEMAND	ON DEMAND	13321	AD2	-
<b>S2 S. 1-13</b>	13260	M114	-	ON DEMAND	13268	13270	14194	AD4	-
<b>S2 DES S.14</b>	13260	M114	-	ON DEMAND	13268	13270	13284	AD4	-

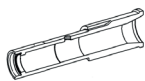

**S1 / S2**

F20 = 13404



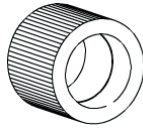

**MOTOR**

**MOTOR  
FAN**

**MOTOR  
PULLEY**

**CODER  
CABLE**

**POWER  
CABLE**

**AMPLIFIER**

**AMPLIFIER  
FAN**

<b>X1</b>	13308	M110	-	13468	ON DEMAND	ON DEMAND	ON DEMAND	AD3	ON DEMAND
<b>A1</b>	14919	M130	-	ON DEMAND	ON DEMAND	ON DEMAND	ON DEMAND	AD2	ON DEMAND
<b>Z2</b>	13308	M220	-	ON DEMAND	ON DEMAND	ON DEMAND	ON DEMAND	AD4	ON DEMAND
<b>Z1</b>	13308	M120	-	13468	ON DEMAND	ON DEMAND	ON DEMAND	AD3	ON DEMAND
<b>T</b>	-	M140	-	ON DEMAND	ON DEMAND	ON DEMAND	ON DEMAND	AD2	ON DEMAND
<b>S1</b>	-	M161	ON DEMAND	ON DEMAND	ON DEMAND	ON DEMAND	13311	AD1	ON DEMAND
<b>S2</b>	-	M261	ON DEMAND	ON DEMAND	ON DEMAND	ON DEMAND	ON DEMAND	AD6	ON DEMAND
<b>ALIM 1</b>	-	-	-	-	-	-	ON DEMAND	AD0	ON DEMAND



<b>A1</b>	14141	13044	13006	12989	500 mm	-	-
<b>X1</b>	14142	13093	13006	12864	525 mm	13459	-
<b>Z1</b>	13466	13093	13006	12864	525 mm	13459	-
<b>Z2</b>	13466	13093	13006	13007	480 mm	-	-
<b>S1</b>	-	-	-	13133	1110 mm	ON DEMAND	-
<b>S2</b>	-	-	-	13131	660 mm	-	-
<b>CODEUR</b>	-	-	-	ON DEMAND	Acc	-	-
<b>ENT CANON</b>	-	-	-	2 x 13003	545 mm	-	-





<b>A1</b>	14141	13044	13006	12989	500 mm	ON DEMAND	ON DEMAND
<b>X1</b>	14142	13093	13006	12864	525 mm	ON DEMAND	ON DEMAND
<b>Z1</b>	13466	13093	13006	12864	525 mm	ON DEMAND	ON DEMAND
<b>X2</b>	14144						
<b>Z2</b>	13466	13093	13006	13007	480 mm	ON DEMAND	ON DEMAND
<b>S1</b>	-	-	-	13133	1110 mm	ON DEMAND	-
<b>S2</b>	-	-	-	13131	660 mm	ON DEMAND	-
<b>CODEUR</b>	-	-	-	ON DEMAND	Acc	ON DEMAND	-
<b>ENT CANON</b>	-	-	-	2 x 13003	545 mm	ON DEMAND	-
<b>T11</b>	-	-	-	14145	-	ON DEMAND	-
<b>T12</b>	-	-	-	14145	-	ON DEMAND	-



**MOTOR**



**MOTOR FAN**



**MOTOR PULLEY**



**CODER CABLE**



**POWER CABLE**



**AMPLIFIER**



**AMPLIFIER FAN**

	<b>MOTOR</b>		<b>MOTOR FAN</b>	<b>MOTOR PULLEY</b>	<b>CODER CABLE</b>	<b>POWER CABLE</b>	<b>AMPLIFIER</b>		<b>AMPLIFIER FAN</b>
<b>X1</b>	13308	M110	-	ON DEMAND	ON DEMAND	ON DEMAND	14313	AD4	ON DEMAND
<b>A1</b>	13308	M130	-	ON DEMAND	ON DEMAND	ON DEMAND	13313	AD3	ON DEMAND
<b>X2</b>	13308	M210	-	ON DEMAND	ON DEMAND	ON DEMAND	14313	AD5	ON DEMAND
<b>Z2</b>	13308	M220	-	ON DEMAND	ON DEMAND	ON DEMAND	14313	AD5	ON DEMAND
<b>Z1</b>	13308	M120	-	ON DEMAND	ON DEMAND	ON DEMAND	14313	AD4	ON DEMAND
<b>T</b>	ON DEMAND	M140	-	ON DEMAND	ON DEMAND	ON DEMAND	13313	AD3	ON DEMAND
<b>S1</b>	ON DEMAND	M161	ON DEMAND	ON DEMAND	ON DEMAND	ON DEMAND	13311	AD1	ON DEMAND
<b>S1 (C1)</b>	ON DEMAND	M161	ON DEMAND	ON DEMAND	ON DEMAND	ON DEMAND	13311	AD1	ON DEMAND
<b>S2</b>	ON DEMAND	M261	ON DEMAND	ON DEMAND	ON DEMAND	ON DEMAND	15331	AD2	0542
<b>ALIM 1</b>	-	-	-	-	-	-	15401	AD0	0552





**Butée conique**

21009



**Alim 24V**

13692



**Kit graissage**

16024



**Chien serrage**

21019

**MICRO 8 - 321A**



**MOTOR**



**MOTOR FAN**

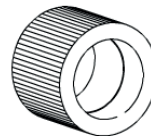

**MOTOR PULLEY**



**CODER CABLE**



**POWER CABLE**

<b>X1 (CH)</b>	15384	<b>M201</b>	-	21212	13370	13371
<b>Y1 (CH)</b>	15382	<b>M301</b>	-	21212	13370	13371
<b>X2 (CH)</b>	13368	<b>M202</b>	-	13906	13370	13371
<b>Z1 (CH)</b>	15384	<b>M401</b>	-	21212	13370	13371
<b>Z4 (CH)</b>	15384	<b>M402</b>	-	13055 14116	13370	13371
<b>S1 (CH)</b>	-	<b>M101</b>	-	-	13901	13372
<b>S4 (CH)</b>	-	<b>M102</b>	-	-	13901	13372
<b>S11 (CH)</b>	13904	<b>M111</b>	-	13000	13370	13902
<b>ALIM (CH1)</b>	-		-	-	-	-
<b>CNC</b>	-		-	-	-	-

# MICRO 8

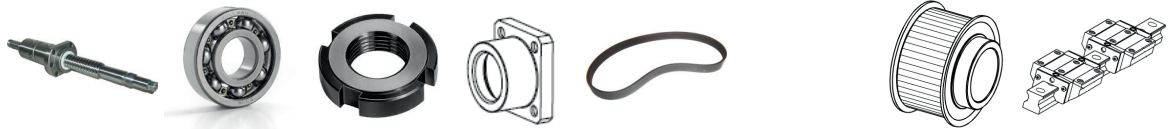

<b>X1</b>	15009	2 x 14928	13006	15214 15215	-	Acc	21212	15239
<b>Y1</b>	14315	2 x 14928	13006	15214 15215	-	Acc	21212	15251
<b>Z1</b>	15010	14929	-	-	-	Acc	21212	16025
<b>Z4</b>	15011	14929	-	-	13760	305 mm	13055 14116	16026
<b>S1</b>	-	-	-	-	-	-	-	-
<b>S4</b>	-	-	-	-	-	-	-	-
<b>S11</b>	-	-	-	-	13907	639 mm	13000	-

# MICRO 8 - 321A



**Till 2010**



**From 2011**



**Till 2010**



**From 2011**

13312	<b>AD201</b>	13312	<b>AD201</b>	12780	21480
13312	<b>AD202</b>	13312	<b>AD202</b>	12780	21480
13312	<b>AD202</b>	13312	<b>AD202</b>	12780	21480
13312	<b>AD201</b>	13312	<b>AD201</b>	12780	21480
13375	<b>AD203</b>	13375	<b>AD203</b>	12780	21480
16035	<b>AD101</b>	13442	<b>AD101</b>	12780 13899	21481 21479
16035	<b>AD102</b>	13442	<b>AD102</b>	12780 13899	21481 21479
-	-	13903	<b>AD111</b>	14982	14982
15362	<b>AD51</b>	13905	<b>AD51</b>	14158 13249	21477 21478
-	-	-	-	2x 21259	2x 14378





**MOTOR**

**MOTOR FAN**

**MOTOR PULLEY**

**CODER CABLE**

**POWER CABLE**

**Amplifier**

**From 2011**

	15384	M201	-	21212	13370	13371	16047	AD201	21480
<b>X1 (CH)</b>	15384	M201	-	21212	13370	13371	16047	AD201	21480
<b>Y1 (CH)</b>	15382	M301	-	21212	13370	13371	16048	AD202	21480
<b>X2 (CH)</b>	13368	M202	-	13906	13370	13371	16048	AD202	21480
<b>Z1 (CH)</b>	15384	M401	-	21212	13370	13371	16047	AD201	21480
<b>Z4 (CH)</b>	15384	M402	-	13055 14116	13370	13371	16048	AD202	21480
<b>S1 (CH)</b>	-	M101	-	-	13901	13372	16044	AD101	21481 21479
<b>S4 (CH)</b>	-	M102	-	-	13901	13372	16044	AD102	21481 21479
<b>S11 (CH)</b>	13904	M111	-	13000	13370	13902	16050	AD111	14982
<b>ALIM (CH1)</b>	-	-	-	-	-	-	16032	AD51	21477 21478
<b>CNC</b>	-	-	-	-	-	-	-	-	2x 14378



**AXE**



<b>X1</b>	30115	ON DEMAND	ON DEMAND	-	ON DEMAND	545	ON DEMAND	ON DEMAND
<b>Y1</b>	30116	ON DEMAND	ON DEMAND	-	ON DEMAND	450	ON DEMAND	ON DEMAND
<b>Z1</b>	30117	ON DEMAND	ON DEMAND	-	ON DEMAND	600	ON DEMAND	ON DEMAND
<b>X4</b>	30118	ON DEMAND	ON DEMAND	-	ON DEMAND	600	ON DEMAND	ON DEMAND
<b>Y4</b>	30119	ON DEMAND	ON DEMAND	-	ON DEMAND	450	ON DEMAND	ON DEMAND
<b>Z4</b>	30120	ON DEMAND	ON DEMAND	-	ON DEMAND	545	ON DEMAND	ON DEMAND
<b>S1</b>	-	-	-	-	-	-	-	-
<b>S11</b>	-	-	-	-	-	-	-	-
<b>S4</b>	-	-	-	-	-	-	-	-
<b>S41</b>	-	-	-	-	-	-	-	-
<b>S10 Canon</b>	-	-	-	-	-	-	-	-



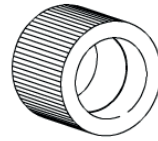

	<b>MOTOR</b>		<b>MOTOR FAN</b>	<b>MOTOR PULLEY</b>	<b>CODER CABLE</b>	<b>POWER CABLE</b>
<b>X1 (CH)</b>	21773	<b>M201</b>	-	ON DEMAND	13370	21775
<b>Y1 (CH)</b>	21773	<b>M301</b>	-	ON DEMAND	13370	21775
<b>Z1 (CH)</b>	21774	<b>M401</b>	-	ON DEMAND	13370	21775
<b>X4 (CH)</b>	21773	<b>M204</b>	-	ON DEMAND	13370	21775
<b>Y4 (CH)</b>	21773	<b>M304</b>	-	ON DEMAND	13370	21775
<b>Z4 (CH)</b>	21774	<b>M404</b>	-	ON DEMAND	13370	21775
<b>S1 (CH)</b>	-	<b>M101</b>	-	ON DEMAND	ON DEMAND	ON DEMAND
<b>S11 (CH)</b>	21772	<b>M111</b>	-	ON DEMAND	13344	13372
<b>S4 (CH)</b>	-	<b>M104</b>	-	ON DEMAND	ON DEMAND	ON DEMAND
<b>S41 (CH)</b>	21772	<b>M141</b>	-	ON DEMAND	13344	13372
<b>S10 (CH) canon</b>	21772	<b>M110</b>	-	-	-	-
<b>ALIM (CH1)</b>	-	-	-	-	-	-

**SIGMA 20/6 - 32/6 311B**

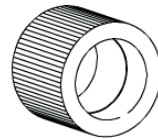

	<b>MOTOR</b>		<b>MOTOR FAN</b>	<b>MOTOR PULLEY</b>	<b>CODER CABLE</b>	<b>POWER CABLE</b>
<b>X1 (CH)</b>	21773	<b>M201</b>	-	ON DEMAND	ON DEMAND	ON DEMAND
<b>Y1 (CH)</b>	21773	<b>M301</b>	-	ON DEMAND	ON DEMAND	ON DEMAND
<b>Z1 (CH)</b>	21774	<b>M401</b>	-	ON DEMAND	ON DEMAND	ON DEMAND
<b>X4 (CH)</b>	21773	<b>M204</b>	-	ON DEMAND	ON DEMAND	ON DEMAND
<b>Y4 (CH)</b>	21773	<b>M304</b>	-	ON DEMAND	ON DEMAND	ON DEMAND
<b>Z4 (CH)</b>	21774	<b>M404</b>	-	ON DEMAND	ON DEMAND	ON DEMAND
<b>S1 (CH)</b>	-	<b>M101</b>	-	ON DEMAND	ON DEMAND	ON DEMAND
<b>S11 (CH)</b>	21772	<b>M111</b>	-	ON DEMAND	ON DEMAND	ON DEMAND
<b>S4 (CH)</b>	-	<b>M104</b>	-	ON DEMAND	ON DEMAND	ON DEMAND
<b>S41 (CH)</b>	21772	<b>M141</b>	-	ON DEMAND	ON DEMAND	ON DEMAND
<b>S10 (CH) canon</b>	21772	<b>M110</b>	-	-	-	-
<b>ALIM (CH1)</b>	-	-	-	-	-	-



**31i**

**31ia**

**AMPLIFIER FAN**

**AMPLIFIER FAN**

13928	<b>AD203</b>	13928	<b>AD203</b>	ON DEMAND	ON DEMAND
13928	<b>AD202</b>	13928	<b>AD202</b>	ON DEMAND	ON DEMAND
13928	<b>AD201</b>	13928	<b>AD201</b>	ON DEMAND	ON DEMAND
13928	<b>AD203</b>	13928	<b>AD203</b>	ON DEMAND	ON DEMAND
13928	<b>AD202</b>	13928	<b>AD202</b>	ON DEMAND	ON DEMAND
13928	<b>AD201</b>	13928	<b>AD201</b>	ON DEMAND	ON DEMAND
16038	<b>AD101</b>	16043	<b>AD101</b>	ON DEMAND	ON DEMAND
16035	<b>AD103</b>	13442	<b>AD103</b>	ON DEMAND	ON DEMAND
16036	<b>AD102</b>	16040	<b>AD102</b>	ON DEMAND	ON DEMAND
16029	<b>AD104</b>	13442	<b>AD104</b>	ON DEMAND	ON DEMAND
16035	<b>AD105</b>	16041	<b>AD105</b>	ON DEMAND	ON DEMAND
16037	<b>AD51</b>	16030	<b>AD51</b>	ON DEMAND	ON DEMAND

**SIGMA 20/6 - 32/6 31IB**



**SIGMA 20 / 6**

**SIGMA 32 / 6**

**AMPLIFIER FAN**

21735	<b>AD201</b>	21735	<b>AD201</b>	ON DEMAND	
21735	<b>AD202</b>	21735	<b>AD202</b>	ON DEMAND	
21735	<b>AD201</b>	21735	<b>AD201</b>	ON DEMAND	
21735	<b>AD202</b>	21735	<b>AD202</b>	ON DEMAND	
21735	<b>AD202</b>	21735	<b>AD202</b>	ON DEMAND	
21735	<b>AD201</b>	21735	<b>AD201</b>	ON DEMAND	
16046	<b>AD101</b>	16044	<b>AD101</b>	ON DEMAND	
16044	<b>AD103</b>	16044	<b>AD103</b>	ON DEMAND	
16046	<b>AD102</b>	16044	<b>AD102</b>	ON DEMAND	
16044	<b>AD104</b>	16044	<b>AD104</b>	ON DEMAND	
16044	<b>AD105</b>	16044	<b>AD105</b>	ON DEMAND	
16033	<b>AD51</b>	16033	<b>AD51</b>	ON DEMAND	





	BALLSCREW	ROLLING	NUT	BELT	BELT-LENGTH	CASE 1
<b>Z1</b>	13495	2 x 13148	2 x 13500	14133	-	14171
<b>X1 OLD</b>	13496	2 x 13148	2 x 13500	13049	<b>390 mm</b>	14171
<b>X2 OLD</b>	13496	2 x 13148	2 x 13500	14133	-	14171
<b>Y1</b>	13497	4 x 13148	2 x 13500	14133	-	14168
<b>Y2</b>	13497	4 x 13148	2 x 13500	14133	-	14168
<b>X3</b>	13493	4 x 13148	2 x 13500	13147	<b>305 mm</b>	14168
<b>Z3</b>	13494	2 x 13148	2 x 13500	13147	<b>305 mm</b>	14171
<b>X4</b>	13499	4 x 13148	2 x 13500	13068	<b>560 mm</b>	14168
<b>Z4</b>	13498	2 x 13148	2 x 13500	13040	<b>610 mm</b>	14171
<b>X1 NEW</b>	13413	2 x 13148 1 x 12791	2 x 13500	13049	<b>390 mm</b>	14166
<b>X2 NEW</b>	13413	2 x 13148 1 x 12791	2 x 13500	14133	-	14166
<b>S1</b>	-	-	-	13648 simple 13675 double	<b>900 mm</b> <b>925 mm</b>	-
<b>S4</b>	-	-	-	13114	<b>840 mm</b>	-
<b>THK</b>	13449	-	-	13008	<b>525 mm</b>	-
<b>S2</b>	-	-	-	13649	<b>900 mm</b>	-
<b>S2</b>	-	-	-	13009	<b>990 mm</b>	-
<b>S2</b>	-	-	-	13650	<b>1215 mm</b>	-
<b>S3</b>	-	-	-	12990	<b>630 mm</b>	-
<b>S3</b>	-	-	-	12864	<b>525 mm</b>	-
<b>S3</b>	-	-	-	13039	<b>355 mm</b>	-
<b>S3</b>	-	-	-	13049	<b>390 mm</b>	-
<b>S3</b>	-	-	-	13068	<b>560 mm</b>	-
<b>S3</b>	-	-	-	13141	<b>340 mm</b>	-
<b>S5</b>	-	-	-	12989	<b>500 mm</b>	-
<b>S5</b>	-	-	-	13049	<b>390 mm</b>	-

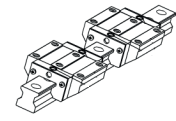
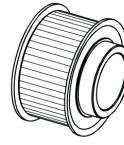
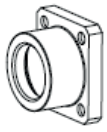

**CASE 2**

**NUT**

**RING**

**JOINT**

**PULLEY**

**LINEAR GUIDE**

14171	-	2 x 14169 2 x 14170	2 x 13144 2 x 13145 2 x 14149	-	15249
14166	-	2 x 14169 1 x 14170	2 x 13144 2 x 13145 2 x 14149	14116 14495	15245
14166	-	2 x 14169 1 x 14170	2 x 13144 2 x 13145 2 x 14149	-	
14168	-	2 x 14169 2 x 14170	2 x 13144 2 x 13145 2 x 14149	-	15239
14168	-	2 x 14169 2 x 14170	2 x 13144 2 x 13145 2 x 14149	-	15239
14168	-	2 x 14169 2 x 14170	2 x 13144 2 x 13145 2 x 14149	14116 14495	15243
14171	-	2 x 14169 2 x 14170	2 x 13144 2 x 13145 2 x 14149	14116 14495	15241
14168	-	2 x 14169 2 x 14170	2 x 13144 2 x 13145 2 x 14149	14116 14495	15247
14171	-	2 x 14169 2 x 14170	2 x 13144 2 x 13145 2 x 14149	14116 14495	15239
14165	14164	14163 14249	13436 13145	14116 14495	15245
14165	14164	14163 14249	13436 13145	-	
-	-	-	-	-	-
-	-	-	-	-	-
-	-	-	-	-	-
-	-	-	-	-	-
-	-	-	-	-	-
-	-	-	-	-	-
-	-	-	-	-	-
-	-	-	-	-	-
-	-	-	-	-	-
-	-	-	-	-	-
-	-	-	-	-	-
-	-	-	-	-	-
-	-	-	-	-	-
-	-	-	-	-	-



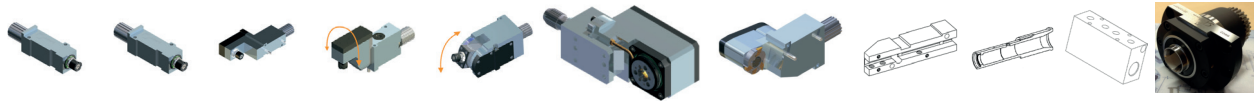

	Axial 15 mm	Axial 30 mm	Radial 90°	R.Ajust 0-180°	Ajust 0-90°	Tourbillonneur	Polygoneur				Guide bush
<b>X1/Y1 (S6)</b>	-	-	-	-	-	-	-	15281	-	-	-
<b>X2/Y2 (S2)</b>	15124	15294	14948	9022	14951	14989	14988	15281	-	-	-
<b>X3/Z3 (S3)</b>	-	-	-	-	-	-	-	-	-	-	-
<b>S5</b>	-	-	-	-	-	-	-	-	-	-	-
<b>S1</b>	-	-	-	-	-	-	-	-	F13 = 15216	-	-
<b>S2</b>	15124	15294	14948	9022	14951	14989	14988	-	-	-	-
<b>CANON</b>	-	-	-	-	-	-	-	-	-	-	15282

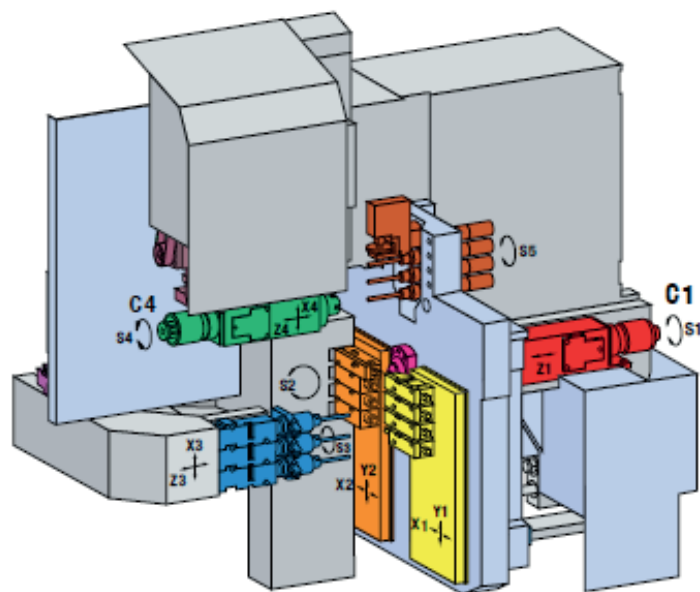

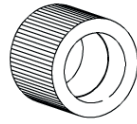

**MOTOR**

**MOTOR FAN**

**MOTOR PULLEY**

**CODER CABLE**

**POWER CABLE**

**AMPLIFIER**

**AMPLIFIER FAN**

	MOTOR		MOTOR FAN	MOTOR PULLEY	CODER CABLE	POWER CABLE	AMPLIFIER		AMPLIFIER FAN
<b>X1 (CH1)</b>	15365	M101	-	14496 14116	12812 12812-5M	12811 12811-5M	15395	AD4	13252
<b>Y1 (CH1)</b>	15366	M102	-	14133	12812 12812-5M	12811 12811-5M	15475	AD5	13243
<b>X2 (CH1)</b>	15365	M104	-	14133	12812 12812-5M	12811 12811-5M	15395	AD4	13252
<b>Y2 (CH2)</b>	15366	M105	-	14133	12812 12812-5M	12811 12811-5M	15475	AD5	13243
<b>Z1 (CH1)</b>	15365	M103	-	14133	12812 12812-5M	12811 12811-5M	15395	AD4	13252
<b>X3 (CH2)</b>	15366	M108	-	14496 14116	12812 12812-5M	12811 12811-5M	15475	AD9	13243
<b>Z3 (CH2)</b>	15365	M109	-	14496 14116	12812 12812-5M	12811 12811-5M	15475	AD9	13243
<b>X4 (CH2)</b>	15366	M110	-	14496 14116	12812 12812-5M	12811 12811-5M	15475	AD10	13243
<b>Z4 (CH2)</b>	15365	M111	-	14496 14116	12812 12812-5M	12811 12811-5M	15475	AD10	13243
<b>S1 (CH1)</b>	15112	M106	12809	14497	13344	14451	15340	AD2	13252
<b>S2 (CH1)</b>	15338	M107	-	13647	13332	13330 13330-5M	15334 15331	AD3	13243
<b>S3 (CH2)</b>	15338	M112	-	14498 14109	13332	13330 13330-5M	15334 15331	AD7	13243
<b>S4 (CH2)</b>	15338	M113	14981	14499 14109	13332	13330 13330-5M	15334 15331	AD8	13243
<b>S5 (CH2)</b>	15104	M115	-	14500 14109	-	13228	13326	AD14	-
<b>ALIM (CH1)</b>	-	-	-	-	-	-	14232	AD1	13252
<b>ALIM (CH2)</b>	-	-	-	-	-	-	14232	AD6	13252





	<b>MOTOR</b>		<b>MOTOR FAN</b>	<b>MOTOR PULLEY</b>		<b>CODER CABLE</b>		<b>POWER CABLE</b>		<b>AMPLIFIER</b>		<b>AMPLIFIER FAN</b>	
<b>X1 (CH1)</b>	15365	M101	-	14496 14116	12812 12812-5M	12811 12811-5M	15389	AD201	13252				
<b>Y1 (CH1)</b>	15366	M102	-	14133	12812 12812-5M	12811 12811-5M	15389	AD201	13243				
<b>X2 (CH1)</b>	15365	M104	-	14133	12812 12812-5M	12811 12811-5M	15404	AD202	13252				
<b>Y2 (CH2)</b>	15366	M105	-	14133	12812 12812-5M	12811 12811-5M	15404	AD202	13243				
<b>Z1 (CH1)</b>	15365	M103	-	14133	12812 12812-5M	12811 12811-5M	15389	AD201	13252				
<b>X3 (CH2)</b>	15366	M108	-	14496 14116	12812 12812-5M	12811 12811-5M	15404	AD203	13243				
<b>Z3 (CH2)</b>	15365	M109	-	14496 14116	12812 12812-5M	12811 12811-5M	15404	AD203	13243				
<b>X4 (CH2)</b>	15366	M110	-	14496 14116	12812 12812-5M	12811 12811-5M	15404	AD204	13243				
<b>Z4 (CH2)</b>	15365	M111	-	14496 14116	12812 12812-5M	12811 12811-5M	15404	AD204	13243				
<b>S1 (CH1)</b>	15112	M106	12809	14497	13344	14451	15340	AD101	13252				
<b>S2 (CH1)</b>	15338	M107	-	13647	13332	13330 13330-5M	15334 15331	AD102	13243				
<b>S3 (CH2)</b>	15338	M112	-	14498 14109	13332	13330 13330-5M	15334 15331	AD103	13243				
<b>S4 (CH2)</b>	15338	M113	14981	14499 14109	13332	13330 13330-5M	15334 15331	AD104	13243				
<b>S5 (CH2)</b>	15104	M115	-	14500 14109	-	13228	13326	AD14	-				
<b>ALIM (CH1)</b>	-	-	-	-	-	-	14232	AD51	13252				
<b>ALIM (CH2)</b>	-	-	-	-	-	-	14232	AD52	13252				





	MOTOR		MOTOR FAN	MOTOR PULLEY	CODER CABLE	POWER CABLE	AMPLIFIER		AMPLIFIER FAN
<b>X1 (CH1)</b>	15384	M201	-	14496 14116	13370	13371	13367	AD201	12780
<b>Y1 (CH1)</b>	15382	M301	-	14133	13370	13371	13367	AD202	12780
<b>X2 (CH1)</b>	15384	M202	-	14133	13370	13371	13367	AD202	12780
<b>Y2 (CH2)</b>	15382	M302	-	14133	13370	13371	16049	AD203	12780
<b>Z1 (CH1)</b>	15384	M401	-	14133	13370	13371	13367	AD201	12780
<b>X3 (CH2)</b>	15382	M203	-	14496 14116	13370	13371	13367	AD204	12780
<b>Z3 (CH2)</b>	15384	M403	-	14496 14116	13370	13371	13367	AD204	12780
<b>X4 (CH2)</b>	15382	M204	-	14496 14116	13370	13371	13367	AD205	12780
<b>Z4 (CH2)</b>	15384	M404	-	14496 14116	13370	13371	13367	AD205	12780
<b>S1 (CH1)</b>	15409	M101	14184	14497 1666	13344	1862	13366	AD101	12780 13899
<b>S2 (CH1)</b>	15407	M102	-	13647	13419	14287	13366	AD102	12780 13899
<b>S3 (CH2)</b>	15085	M103	-	14498 14109	13419	14287	13366	AD103	12780 13899
<b>S4 (CH2)</b>	15407	M104	14981	14499 14109	13419	14287	13366	AD104	12780 13899
<b>S5 (CH2)</b>	15407	M105	-	14500 14109	13419	14287	13366	AD105	12780 13899
<b>ALIM (CH1)</b>	-	-	-	-	-	-	15362	AD51	13249 14158
<b>ALIM (CH2)</b>	-	-	-	-	-	-	15362	AD52	13249 14158



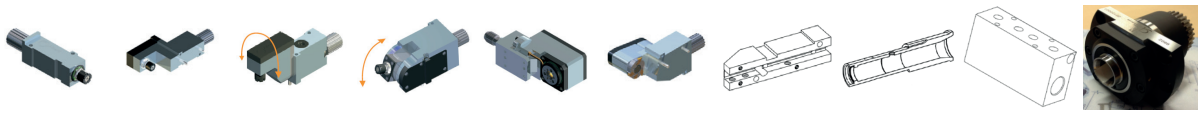

<b>X1/Y1 (S6)</b>	14952	14955	14990	14958	14959	14993	15289 21680	-	21433	-
<b>X2/Y2 (S2)</b>	14952	14955	14990	14958	14959	14993	15289 21680	-	21433	-
<b>X3/Z3 (S3)</b>	-	-	-	-	-	-	-	-	21433	-
<b>S5</b>	14952	14955	14990	14958	-	-	15289 21680	-	21433	-
<b>S1</b>	-	-	-	-	-	-	-	F20 = 15163	-	21681
<b>S4</b>	-	-	-	-	-	-	-	F20 = 15162	-	-
<b>S2</b>	14952	14955	14990	14958	14959	14993	15289		21433	-

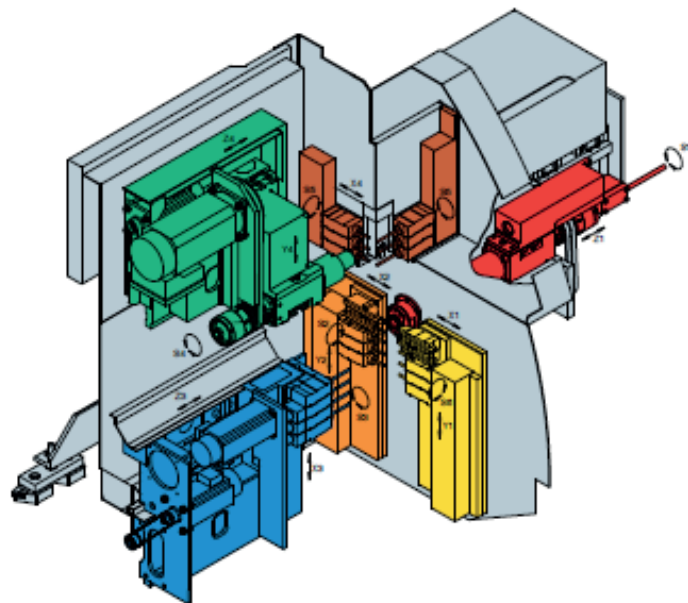



<b>X1</b>	Module 13403 VàB 13503	4 x 13349	2 x 13514	13141	<b>340 mm</b>	13511 12735	14724
<b>X2</b>	Module 13403 VàB 13503	4 x 13349	2 x 13514	13141	<b>340 mm</b>	13511 12735	14724
<b>Y1</b>	Module 13408 VàB 13521	6 x 13349	2 x 13514	13039	<b>355 mm</b>	13511 12735	14716 (old: 14778)
<b>Y2</b>	Module 13408 VàB 13521	6 x 13349	2 x 13514	13039	<b>355 mm</b>	13511 12735	14716 (old: 14778)
<b>Z3</b>	Module 13408 VàB 13521	6 x 13349	2 x 13514	13141	<b>545 mm</b>	13511 12735	14720
<b>Z4</b>	Module 13408 VàB 13521	6 x 13349	2 x 13514	13069	<b>510 mm</b>	13511 12735	14720
<b>X4</b>	Module 13408 VàB 13521	6 x 13349	2 x 13514	13070 / 13078	<b>455 mm / 420 mm</b>	13511 12735	14721
<b>X3</b>	Module 13404 VàB 13509	6 x 13349	2 x 13514	13078	<b>420 mm</b>	13511 12735	14723
<b>Z1</b>	Module 13412 VàB 13525	6 x 13349	2 x 13514	12990	<b>630 mm</b>	13511 12735	14722
<b>Y4</b>	Module 13412 VàB 13525	6 x 13349	2 x 13514	13078	<b>420 mm</b>	13511 12735	14723
<b>S1 DECO 13</b>	-	-	-	2 x 13213	<b>1750 mm</b>	-	-
<b>S4 DECO 13</b>	-	-	-	13207	<b>1140 mm</b>	-	-
<b>S1 DECO 13a</b>	-	-	-	2 x 14186	<b>1010 mm</b>	-	-
<b>S4 DECO 13a</b>	-	-	-	13215	<b>980 mm</b>	-	-
<b>S2</b>	-	-	-	13007	<b>480 mm</b>	-	-
<b>S2</b>	-	-	-	13114	<b>840 mm</b>	-	-
<b>S3</b>	-	-	-	13077	<b>575 mm</b>	-	-
<b>S5</b>	-	-	-	13009	<b>990 mm</b>	-	-
<b>S5</b>	-	-	-	13048	<b>280 mm</b>	-	-
<b>S6</b>	-	-	-	13007	<b>480 mm</b>	-	-
<b>S6</b>	-	-	-	13114	<b>840 mm</b>	-	-
<b>CANON</b>	-	-	-	14146	<b>690 mm</b>	-	-





	MOTOR		MOTOR FAN	MOTOR PULLEY	CODER CABLE	POWER CABLE	AMPLIFIER		AMPLIFIER FAN
<b>X1 (CH1)</b>	13380	M201	-	13512 13168	12812	12811	15355	AD201	2 x 13243
<b>Y1 (CH1)</b>	15368	M301	-	13512 13168	12812	12811	15355	AD201	2 x 13243
<b>X2 (CH1)</b>	13380	M202	-	13512 13168	12812	12811	15355	AD202	2 x 13243
<b>Y2 (CH1)</b>	15368	M302	-	13512 13168	12812	12811	15355	AD202	2 x 13243
<b>Z1 (CH1)</b>	13380	M401	-	13512 13168	12812	12811	15352	AD203	2 x 13243
<b>X3 (CH2)</b>	15368	M203	-	13512 13168	12812	12811	15355	AD204	2 x 13243
<b>Z3 (CH2)</b>	13380	M403	-	13512 13168	12812	12811	15355	AD204	2 x 13243
<b>X4 (CH2)</b>	13380	M204	-	13512 13168	12812	12811	15355	AD205	2 x 13243
<b>Y4 (CH1)</b>	15368	M304	-	13512 13168	12812	12811	15352	AD206	2 x 13243
<b>Z4 (CH2)</b>	13380	M404	-	13512 13168	12812	12811	15355	AD205	2 x 13243
<b>S1 (CH1)</b>	14717	M101	12809	14510 14113	13344	14451	15340	AD101	13252
<b>S2 (CH1)</b>	15338	M102	-	14506 13168	13332	13330	15331	AD102	13243
<b>S3 (CH2)</b>	14718	M103	-	14509	14283	13330	15331	AD103	13243
<b>S4 (CH2)</b>	15359	M104	12809	14507 14110	13344	14451	15331	AD104	13243
<b>S5 (CH2)</b>	15359	M105	12809	14508	13344	14451	15331	AD105	13243
<b>S6 (CH1)</b>	14718	M106	-	14506 13168	14283	13330	15331	AD106	13243
<b>ALIM (CH1)</b>	-	-	-	-	-	-	15401	AD51	13252
<b>ALIM (CH2)</b>	-	-	-	-	--	-	15401	AD52	13252

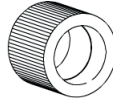

	MOTOR		MOTOR FAN	MOTOR PULLEY	CODER CABLE	POWER CABLE	AMPLIFIER		AMPLIFIER FAN
<b>X1 (CH1)</b>	13368	M201	-	13512 13168	13370	15472	13367	AD201	12780
<b>Y1 (CH1)</b>	13369	M301	-	13512 13168	13370	15472	13367	AD201	12780
<b>X2 (CH1)</b>	13368	M202	-	13512 13168	13370	15472	13367	AD202	12780
<b>Y2 (CH1)</b>	13369	M302	-	13512 13168	13370	15472	13367	AD202	12780
<b>Z1 (CH1)</b>	13368	M401	-	13512 13168	13370	15472	16049	AD203	12780
<b>X3 (CH2)</b>	13369	M203	-	13512 13168	13370	15472	13367	AD204	12780
<b>Z3 (CH2)</b>	13368	M403	-	13512 13168	13370	15472	13367	AD204	12780
<b>X4 (CH2)</b>	13368	M204	-	13512 13168	13370	15472	13367	AD205	12780
<b>Y4 (CH1)</b>	13369	M304	-	13512 13168	13370	15472	16049	AD206	12780
<b>Z4 (CH2)</b>	13368	M404	-	13512 13168	13370	15472	13367	AD205	12780
<b>S1 (CH1)</b>	14764	M101	12809	14251 14113	13344	13372	13366	AD101	12780 13899
<b>S2 (CH1)</b>	15407	M102	-	14506 13168	13419	14287	13366	AD102	12780 13899
<b>S3 (CH2)</b>	15085	M103	-	14509	13419	14287	13366	AD103	12780 13899
<b>S4 (CH2)</b>	14259	M104	14184	14507 14110	13344	13372	13366	AD104	12780 13899
<b>S5 (CH2)</b>	14259	M105	14184	14508	13344	13372	13366	AD105	12780 13899
<b>S6 (CH1)</b>	15085	M106	-	14506 13168	13419	14287	13366	AD106	12780 13899
<b>ALIM (CH1)</b>	-	-	-	-	-	-	15362	AD51	13249 14158
<b>ALIM (CH2)</b>	-	-	-	-	-	-	15362	AD52	13249 14158





<b>Z1</b>	Module 13405 VàB 13510	4 x 13349	2 x 13514	13077	575 mm	13511 12735	ON DEMAND
<b>X2</b>	Module 13408 VàB 13521	6 x 13349	2 x 13514	13077	575 mm	13511 12735	ON DEMAND
<b>Z2</b>	Module 13408 VàB 13521	6 x 13349	2 x 13514	13078	420 mm	13511 12735	ON DEMAND
<b>Y2</b>	Module 13404 VàB 13509	6 x 13349	2 x 13514	13078	420 mm	13511 12735	ON DEMAND
<b>X1</b>	Module 13405 VàB 13510	6 x 13349	2 x 13514	13071	720 mm	13511 12735	ON DEMAND
<b>Y1</b>	Module 13405 VàB 13510	6 x 13349	2 x 13514	12990	630 mm	13511 12735	ON DEMAND
<b>S1</b>	-	-	-	13043	810 mm	-	-
<b>S1 A ENT</b>	-	-	-	13214	660 mm	-	-
<b>ENT A CAN</b>	-	-	-	13383	660 mm	-	-
<b>S2</b>	-	-	-	12989	500 mm	-	-
<b>S3</b>	-	-	-	13114	840 mm	-	-
<b>S3</b>	-	-	-	13114	780 mm	-	-



	<b>MOTOR</b>		<b>MOTOR FAN</b>	<b>MOTOR PULLEY</b>	<b>CODER CABLE</b>	<b>POWER CABLE</b>	<b>AMPLIFIER</b>		<b>AMPLIFIER FAN</b>
<b>X1 (CH1)</b>	13380	M201	-	13512 13168	12812	12811	15119	AD201	13252
<b>Y1 (CH1)</b>	15368	M301	-	13512 13168	12812	12811	15119	AD201	13252
<b>X2 (CH2)</b>	13380	M202	-	13512 13168	12812	12811	15119	AD202	13252
<b>Y2 (CH2)</b>	15368	M302	-	13512 13168	12812	12811	15119	AD202	13252
<b>Z1 (CH1)</b>	13380	M401	-	13512 13168	12812	12811	15119	AD201	13252
<b>Z2 (CH2)</b>	13380	M402	-	13512 13168	12812	12811	15119	AD202	13252
<b>S1 (CH1)</b>	14717	M101	12809	14510 14113	13344	14451	15340	AD101	13252
<b>S2 (CH2)</b>	15359	M102	12809	14507 14110	13344	14451	15331	AD102	13243
<b>S3 (CH1)</b>	15338	M103	-	2711 13168	13332	13330	15331	AD103	13243
<b>ALIM (CH1)</b>	-	-	-	-	-	-	15401	AD51	13252



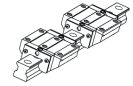
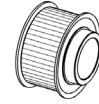
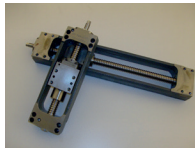

<b>X1</b>	Module 13403 VàB 13503	4 x 13349	2 x 13514	13147	305 mm	13511 12735	13179
<b>X2</b>	Module 13403 VàB 13503	4 x 13349	2 x 13514	13050	690 mm	13511 12735	13179
<b>Y1</b>	Module 13404 VàB 13509	6 x 13349	2 x 13514	13039	355 mm	13511 12735	13180
<b>Y2</b>	Module 13404 VàB 13509	6 x 13349	2 x 13514	13039	355 mm	13511 12735	13180
<b>Y4</b>	Module 13404 VàB 13509	6 x 13349	2 x 13514	13149	620 mm	13511 12735	13836
<b>Z3</b>	Module 13405 VàB 13510	6 x 13349	2 x 13514	13051 / 13077	545 / 575 mm	13511 12735	13837
<b>X3</b>	Module 13405 VàB 13510	6 x 13349	2 x 13514	13039	355 mm	13511 12735	13838
<b>Z4</b>	Module 30002 VàB 13525	6 x 13349	2 x 13514	13078	420 mm	13511 12735	13837
<b>X4 DECO 20</b>	Module 13412 VàB 13525	6 x 13349	2 x 13514	13077	575 mm	13511 12735	13836
<b>X4 DECO 20a</b>	Module 14138 VàB 14307	6 x 14513	2 x 12969	13160	480 mm	14512 14119	13836
<b>Z1 DECO 20</b>	Module 13405 VàB 13510	6 x 13349	2 x 13514	12989	500 mm	13511 12735	13836
<b>Z1 DECO 20a</b>	Module 30002 VàB 13525	6 x 13349	2 x 13514	12989	500 mm	13511 12735	13839





<b>S1 *</b>	-	-	-	2 x 13182	1150 mm	-	-
<b>S1</b>	-	-	-	2 x 13181	1300 mm	-	-
<b>CANON</b>	-	-	-	13183	690 mm	-	-
<b>CODEUR</b>	-	-	-	12762	Acc	-	-
<b>S2</b>	-	-	-	13185	400 mm	-	-
<b>S2</b>	-	-	-	13184	1315 mm	-	-
<b>S3</b>	-	-	-	13184	1315 mm	-	-
<b>S4 DECO 20</b>	-	-	-	13343	575 mm	-	-
<b>S4 DECO 20</b>	-	-	-	13047	780 mm	-	-
<b>S4</b>	-	-	-	13011	920 mm	-	-
<b>S5 L</b>	-	-	-	13160	480 mm	-	-
<b>S5 L</b>	-	-	-	13586	990 mm	-	-
<b>S5 L</b>	-	-	-	13392	650 mm	-	-
<b>S5 T</b>	-	-	-	13184	1315 mm	-	-
<b>S6</b>	-	-	-	12959	750 mm	-	-
<b>S6</b>	-	-	-	12872	620 mm	-	-



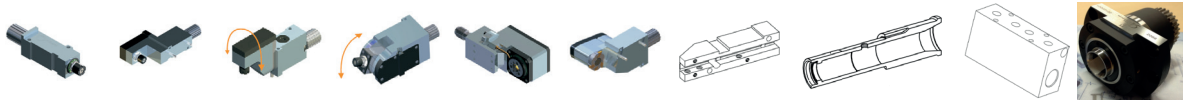

<b>X1/Y1 (S6)</b>	15074	14963	14970	-	14967	15003	15169 21679	-	15446	-
<b>X2/Y2 (S2)</b>	15074	14963	14970	-	14967	15003	15169 21679	-	15446	-
<b>X3/Z3 (S3)</b>	15074	-	14970	-	-	-	-	-	15446	-
<b>S5</b>	15074	14963	14970	-	-	-	15169 21679	-	15446	-
<b>S1</b>	-	-	-	-	-	-	-	F25 = 13506 F30 = 13517	-	21036
<b>S4</b>	-	-	-	-	-	-	-		-	-
<b>S2</b>	15074	14963	14970	-	-	-	-	-	-	-

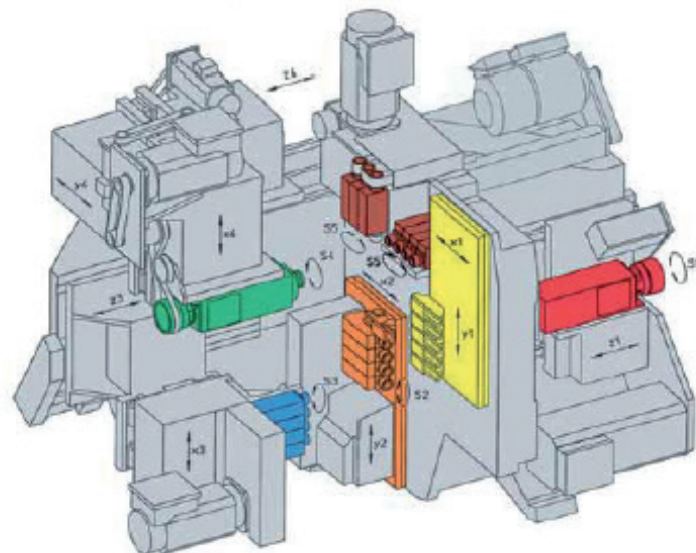

# DECO 20 - 16ITA



	MOTOR		MOTOR FAN	MOTOR PULLEY	CODER CABLE	POWER CABLE	SERIE 1 - 3 AMPLIFIER		SERIE 1 - 3 AMPLIFIER FAN	DES SERIE 4 AMPLIFIER		DES SERIE 4 AMPLIFIER FAN
<b>X1 (CH1)</b>	13380	M201	-	13512 13168	12812	12811	15343	AD201	13243	15355	AD201	2 x 13243
<b>Y1 (CH1)</b>	15368	M301	-	13512 13168	12812	12811	15343	AD201	13243	15355	AD201	2 x 13243
<b>X2 (CH1)</b>	15368	M202	-	13512 13168	12812	12811	15343	AD202	13243	15355	AD202	2 x 13243
<b>Y2 (CH1)</b>	15368	M302	-	13512 13168	12812	12811	15343	AD202	13243	15355	AD202	2 x 13243
<b>Z1 (CH1)</b>	13380	M401	-	13512 13168	12812	12811	14290	AD203	13243	15352	AD203	2 x 13243
<b>X3 (CH2)</b>	15368	M203	-	13512 13168	12812	12811	15343	AD204	13243	15355	AD204	2 x 13243
<b>Z3 (CH2)</b>	13380	M403	-	13512 13168	12812	12811	15343	AD204	13243	15355	AD204	2 x 13243
<b>X4 (CH2)</b>	15368	M204	-	13512 13168	12812	12811	15343	AD205	13243	15355	AD205	2 x 13243
<b>Y4 (CH2)</b>	15368	M304	-	13512 13168	12812	12811	15343	AD205	13243	15355	AD205	2 x 13243
<b>Z4 (CH1)</b>	13380	M404	-	13512 13168	12812	12811	14290	AD206	13243	15352	AD206	2 x 13243
<b>S1 (CH1)</b>	14972	M101	14244	14501 14114	13344	14284	15340	AD101	13252	15340	AD101	13252
<b>S2 (CH1)</b>	15347	M102	12809	2 x 14503 14119 14110	13344	14451	15331	AD102	13243	15331	AD102	13243
<b>S3 (CH2)</b>	13345	M103	12809	1857	14161	14451	15349	AD103	13243	15349	AD103	13243
<b>S4 (CH2)</b>	15347	M104	12809	14119 14110	13344	14451	15331	AD104	13243	15331	AD104	13243
<b>S5 (CH2)</b>	13359	M105 M106	13350	14504	-	13227	13360	AD2	-	13360	AD2	-
<b>S6 (CH2)</b>	13376	M107	-	14505	14152	14285	15106	AD107	-	15106	AD107	-
<b>ALIM (CH1)</b>	-	-	-	-	-	-	14232	AD51	13252	15401	AD51	13252
<b>ALIM (CH2)</b>	-	-	-	-	-	-	14232	AD52	13252	15401	AD52	13252



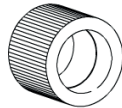

	<b>MOTOR</b>		<b>MOTOR FAN</b>	<b>MOTOR PULLEY</b>	<b>CODER CABLE</b>	<b>POWER CABLE</b>	<b>AMPLIFIER</b>		<b>AMPLIFIER FAN</b>
<b>X1 (CH1)</b>	13368	M201	-	13512 13168	13370	13371	13367	AD201	12780
<b>Y1 (CH1)</b>	13369	M301	-	13512 13168	13370	13371	13367	AD201	12780
<b>X2 (CH1)</b>	13369	M202	-	13512 13168	13370	13371	13367	AD202	12780
<b>Y2 (CH1)</b>	13369	M302	-	13512 13168	13370	13371	13367	AD202	12780
<b>Z1 (CH1)</b>	13368	M401	-	13512 13168	13370	13371	13367	AD203	12780
<b>X3 (CH2)</b>	13369	M203	-	13512 13168	13370	13371	13367	AD204	12780
<b>Z3 (CH2)</b>	13368	M403	-	13512 13168	13370	13371	13367	AD204	12780
<b>X4 (CH2)</b>	13369	M204	-	13512 13168	13370	13371	13367	AD205	12780
<b>Y4 (CH2)</b>	13369	M304	-	13512 13168	13370	13371	13367	AD205	12780
<b>Z4 (CH1)</b>	13368	M404	-	13512 13168	13370	13371	13367	AD203	12780
<b>S1 (CH1)</b>	14974	M101	14228	14501 14114	13344	13374	13373	AD101	12780 14158
<b>S2 (CH1)</b>	14259	M102	14184	2 x 14503 14119 14110	13344	13372	13366	AD102	12780 13899
<b>S3 (CH2)</b>	14259	M103	14184	1857	13344	13372	13366	AD103	12780 13899
<b>S4 (CH2)</b>	15409	M104	14184	14502 14112	13344	13372	13366	AD104	12780 13899
<b>S5 (CH2)</b>	13359	M105 M106	13350	14504	13227	13228	13360	AD2	-
<b>S6 (CH2)</b>	13376	M107	-	14505	14152	14285	15106	AD107	-
<b>ALIM (CH1)</b>	-	-	-	-	-	-	15362	AD51	13249 14158
<b>ALIM (CH2)</b>	-	-	-	-	-	-	15362	AD52	13249 14158

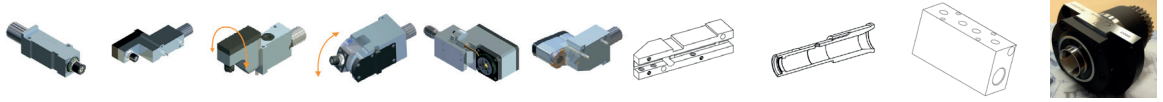

<b>X1/Y1 (S6)</b>	15074	14963	14970	-	14967	15003	15169 21679	-	15446	-
<b>X2/Y2 (S2)</b>	15074	14963	14970	-	14967	15003	15169 21679	-	15446	-
<b>X3/Z3 (S3)</b>	15074	-	14970	-	-	-	-	-	15446	-
<b>S5</b>	15074	14963	14970	-	-	-	15169 21679	-	15446	-
<b>S1</b>	-	-	-	-	-	-	-	F25 = 13506 F30 = 13517	-	ON DEMAND
<b>S4</b>	-	-	-	-	-	-	-	F37 = 15161 F37 = 15160	-	-
<b>S2</b>	15074	14963	14970	-	-	-	-	-	-	-

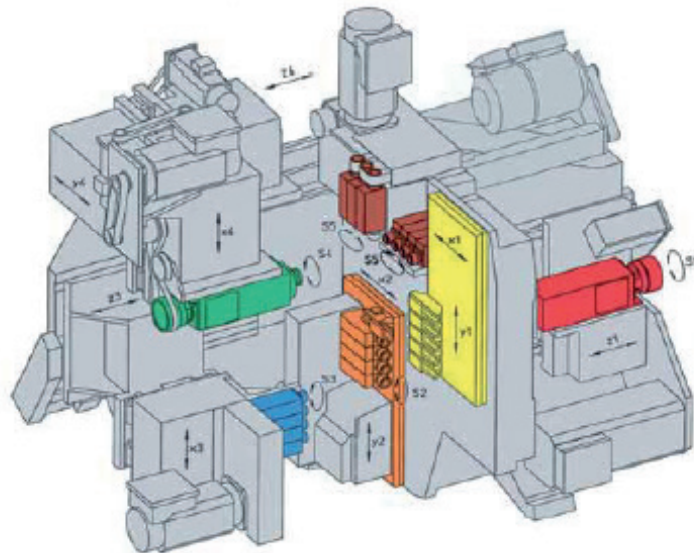



<b>X1</b>	Module 13403 VàB 13503	4 x 13349	2 x 13514	13147	305 mm	13511 12735	13179
<b>X2</b>	Module 13403 VàB 13503	4 x 13349	2 x 13514	13050	690 mm	13511 12735	13179
<b>Y1</b>	Module 13404 VàB 13509	6 x 13349	2 x 13514	13039	355 mm	13511 12735	13180
<b>Y2</b>	Module 13404 VàB 13509	6 x 13349	2 x 13514	13039	355 mm	13511 12735	13180
<b>Y4</b>	Module 13404 VàB 13509	6 x 13349	2 x 13514	13149	620 mm	13511 12735	13836
<b>Z3</b>	Module 13405 VàB 13510	6 x 13349	2 x 13514	13051 / 13077	545 / 575 mm	13511 12735	13837
<b>X3</b>	Module 13405 VàB 13510	6 x 13349	2 x 13514	13039	355 mm	13511 12735	13838
<b>Z4</b>	Module 30002 VàB 13525	6 x 13349	2 x 13514	13078	420 mm	13511 12735	13837
<b>X4 DECO 20</b>	Module 13412 VàB 13525	6 x 13349	2 x 13514	13077	575 mm	13511 12735	13836
<b>X4 DECO 20a</b>	Module 14138 VàB 14307	6 x 14513	2 x 12969	13160	480 mm	14512 14119	13836
<b>Z1 DECO 20</b>	Module 13405 VàB 13510	6 x 13349	2 x 13514	12989	500 mm	13511 12735	13836
<b>Z1 DECO 20a</b>	Module 30002 VàB 13525	6 x 13349	2 x 13514	12989	500 mm	13511 12735	13839

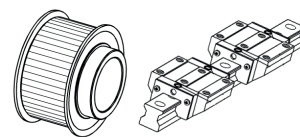

<b>S1*</b>	-	-	-	2 x 13182	1150 mm	-	-
<b>S1</b>	-	-	-	2 x 13181	1300 mm	-	-
<b>CANON</b>	-	-	-	13183	690 mm	-	-
<b>CODEUR</b>	-	-	-	12762	Acc	-	-
<b>S2</b>	-	-	-	13185	400 mm	-	-
<b>S2</b>	-	-	-	13184	1315 mm	-	-
<b>S3</b>	-	-	-	13184	1315 mm	-	-
<b>S4</b>	-	-	-	13343	575 mm	-	-
<b>DECO 26</b>	-	-	-	13047	780 mm	-	-
<b>S4</b>	-	-	-	13011	920 mm	-	-
<b>S5 L</b>	-	-	-	13160	480 mm	-	-
<b>S5 L</b>	-	-	-	13586	990 mm	-	-
<b>S5 L</b>	-	-	-	13392	650 mm	-	-
<b>S5 T</b>	-	-	-	13184	1315 mm	-	-
<b>S6</b>	-	-	-	12959	750 mm	-	-
<b>S6</b>	-	-	-	12872	620 mm	-	-





	MOTOR		MOTOR FAN	MOTOR PULLEY	CODER CABLE	POWER CABLE	DES SERIE 4 AMPLIFIER		AMPLIFIER FAN
<b>X1 (CH1)</b>	13380	M201	-	13512 13168	12812	12811	15355	AD201	2 x 13243
<b>Y1 (CH1)</b>	15368	M301	-	13512 13168	12812	12811	15355	AD201	2 x 13243
<b>X2 (CH1)</b>	15368	M202	-	13512 13168	12812	12811	15355	AD202	2 x 13243
<b>Y2 (CH1)</b>	15368	M302	-	13512 13168	12812	12811	15355	AD202	2 x 13243
<b>Z1 (CH1)</b>	13380	M401	-	13512 13168	12812	12811	15352	AD203	2 x 13243
<b>X3 (CH2)</b>	15368	M203	-	13512 13168	12812	12811	15355	AD204	2 x 13243
<b>Z3 (CH2)</b>	13380	M403	-	13512 13168	12812	12811	15355	AD204	2 x 13243
<b>X4 (CH2)</b>	15368	M204	-	13512 13168	12812	12811	15355	AD205	2 x 13243
<b>Y4 (CH2)</b>	15368	M304	-	13512 13168	12812	12811	15355	AD205	2 x 13243
<b>Z4 (CH1)</b>	13380	M404	-	13512 13168	12812	12811	15352	AD206	13243
<b>S1 (CH1)</b>	9029	M101	14244	14501 14114	13344	14284	14314	AD101	13252
<b>S2 (CH1)</b>	15347	M102	12809	2 x 14503 14119 14110	13344	14451	15331	AD102	13243
<b>S3 (CH2)</b>	13345	M103	12809	1857	14161	14451	15349	AD103	13243
<b>S4 (CH2)</b>	13345	M104	12809	14503 14110	13344	14451	15340	AD104	13243
<b>S5 (CH2)</b>	13359	M105 M106	13350	14504	-	13227	13360	AD2	-
<b>S6 (CH2)</b>	13376	M107	-	14505	14152	14285	15106	AD107	-
<b>ALIM (CH1)</b>	-	-	-	-	-	-	15401	AD51	13252
<b>ALIM (CH2)</b>	-	-	-	-	-	-	15401	AD52	13252





	MOTOR		MOTOR FAN	MOTOR PULLEY	CODER CABLE	POWER CABLE	AMPLIFIER		AMPLIFIER FAN
<b>X1 (CH1)</b>	13368	M201	-	13512 13168	13370	13371	13367	AD201	12780
<b>Y1 (CH1)</b>	13369	M301	-	13512 13168	13370	13371	13367	AD201	12780
<b>X2 (CH1)</b>	13369	M202	-	13512 13168	13370	13371	13367	AD202	12780
<b>Y2 (CH1)</b>	13369	M302	-	13512 13168	13370	13371	13367	AD202	12780
<b>Z1 (CH1)</b>	13368	M401	-	13512 13168	13370	13371	13367	AD203	12780
<b>X3 (CH2)</b>	13369	M203	-	13512 13168	13370	13371	13367	AD204	12780
<b>Z3 (CH2)</b>	13368	M403	-	13512 13168	13370	13371	13367	AD204	12780
<b>X4 (CH2)</b>	13369	M204	-	13512 13168	13370	13371	13367	AD205	12780
<b>Y4 (CH2)</b>	13369	M304	-	13512 13168	13370	13371	13367	AD205	12780
<b>Z4 (CH1)</b>	13368	M404	-	13512 13168	13370	13371	13367	AD203	12780
<b>S1 (CH1)</b>	14974	M101	14228	14501 14114	13344	13374	13373	AD101	12780 14158
<b>S2 (CH1)</b>	14259	M102	14184	2 x 14503 14119 14110	13344	13372	13366	AD102	12780 13899
<b>S3 (CH2)</b>	14259	M103	14184	1857	13344	13372	13366	AD103	12780 13899
<b>S4 (CH2)</b>	14259	M104	14184	14503 14110	13344	13372	13366	AD104	12780 13899
<b>S5 (CH2)</b>	13359	M105 M106	13350	14504	13227	13228	13360	AD2	-
<b>S6 (CH2)</b>	13376	M107	-	14505	14152	14285	15106	AD107	-
<b>ALIM (CH1)</b>	-	-	-	-	-	-	15362	AD51	13249 14158
<b>ALIM (CH2)</b>	-	-	-	-	-	-	15362	AD52	13249 14158





	<b>BALLSCREW</b>	<b>ROLLING</b>	<b>NUT</b>	<b>BELT</b>	<b>BELT-LENGTH</b>	<b>CASE 1</b>
<b>Z1</b>	13495	2 x 13148	2 x 13500	-	-	21357
<b>X1</b>	13805	2 x 13349	13514	13049	<b>390 mm</b>	13770
<b>X2</b>	13805	2 x 13349	13514	-	-	13770
<b>Y1</b>	13497	4 x 13148	2 x 13500	-	-	14168
<b>Y2</b>	13497	4 x 13148	2 x 13500	-	-	14168
<b>X3</b>	13493	4 x 13148	2 x 13500	13147	<b>305 mm</b>	14168
<b>Z3</b>	13494	2 x 13148	2 x 13500	13147	<b>305 mm</b>	14171
<b>X4</b>	13499	4 x 13148	2 x 13500	13068	<b>560 mm</b>	14168
<b>Z4</b>	16032	2 x 13148	2 x 13500	-	-	14171
<b>S1</b>	-	-	-	-	-	-
<b>S4</b>	-	-	-	-	-	-
<b>THK</b>	-	-	-	12991 2x	<b>455 mm</b>	-
<b>S2</b>	-	-	-	13649	<b>900 mm</b>	-
<b>S2</b>	-	-	-	13009	<b>990 mm</b>	-
<b>S2</b>	-	-	-	13650	<b>1215 mm</b>	-
<b>S3</b>	-	-	-	13141	<b>340 mm</b>	-
<b>S3</b>	-	-	-	13039	<b>355 mm</b>	-
<b>S3</b>	-	-	-	13049	<b>390 mm</b>	-
<b>S3</b>	-	-	-	12864	<b>525 mm</b>	-
<b>S3</b>	-	-	-	13068	<b>560 mm</b>	-
<b>S5</b>	-	-	-	13049	<b>390 mm</b>	-
<b>S5</b>	-	-	-	12989	<b>500 mm</b>	-

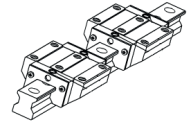
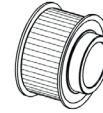

**CASE 2      NUT      RING      JOINT      PULLEY      LINEAR GUIDE**

<b>Z1</b>	14171	-	2 x 14170 2 x 14169	2 x 13144 2 x 13145 2 x 14149	14133	21356
<b>X1</b>	-	21063	2 x 21064	2 x 13145	14495 14116	15245
<b>X2</b>	-	21063	2 x 21064	2 x 13145	14133	
<b>Y1</b>	14168	-	2 x 14170 2 x 14169	2 x 13144 2 x 13145 2 x 14149	14133	15239
<b>Y2</b>	14168	-	2 x 14170 2 x 14169	2 x 13144 2 x 13145 2 x 14149	14133	15239
<b>X3</b>	14168	-	2 x 14170 2 x 14169	2 x 13144 2 x 13145 2 x 14149	14495 14116	21754
<b>Z3</b>	14171	-	2 x 14170 2 x 14169	2 x 13144 2 x 13145 2 x 14149	14495 14116	15421
<b>X4</b>	21606	-	2 x 14170 2 x 14169	2 x 13144 2 x 13145 2 x 14149	14495 14116	21755
<b>Z4</b>	14171	-	2 x 14170 2 x 14169	2 x 13144 2 x 13145 2 x 14149	14133	21747
<b>S1</b>	-	-	-	-	-	-
<b>S4</b>	-	-	-	-	-	-
<b>THK</b>	-	-	-	-	-	-
<b>S2</b>	-	-	-	-	-	-
<b>S2</b>	-	-	-	-	-	-
<b>S2</b>	-	-	-	-	-	-
<b>S3</b>	-	-	-	-	-	-
<b>S3</b>	-	-	-	-	-	-
<b>S3</b>	-	-	-	-	-	-
<b>S3</b>	-	-	-	-	-	-
<b>S3</b>	-	-	-	-	-	-
<b>S5</b>	-	-	-	-	-	-
<b>S5</b>	-	-	-	-	-	-



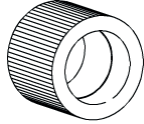

		<b>MOTOR</b>	<b>MOTOR FAN</b>	<b>MOTOR PULLEY</b>	<b>CODER CABLE</b>	<b>POWER CABLE</b>	<b>AMPLIFIER</b>	<b>AMPLIFIER FAN</b>	
<b>X1 (CH1)</b>	15384	<b>M201</b>	-	14496 14116	13370	13371	13312	<b>AD201</b>	12780
<b>Y1 (CH1)</b>	15382	<b>M301</b>	-	14133	13370	13371	13312	<b>AD202</b>	12780
<b>X2 (CH1)</b>	15384	<b>M202</b>	-	14133	13370	13371	13312	<b>AD202</b>	12780
<b>Y2 (CH2)</b>	15382	<b>M302</b>	-	14133	13370	13371	13312	<b>AD203</b>	12780
<b>Z1 (CH1)</b>	15384	<b>M401</b>	-	14133	13370	13371	13312	<b>AD201</b>	12780
<b>X3 (CH2)</b>	15382	<b>M203</b>	-	14496 14116	13370	13371	13312	<b>AD203</b>	12780
<b>Z3 (CH2)</b>	15384	<b>M403</b>	-	14496 14116	13370	13371	13312	<b>AD204</b>	12780
<b>X4 (CH2)</b>	15382	<b>M204</b>	-	14496 14116	13370	13371	13312	<b>AD204</b>	12780
<b>Z4 (CH2)</b>	15384	<b>M404</b>	-	14133	13370	13371	13312	<b>AD205</b>	12780
<b>Y4 (CH2)</b>	15382	<b>M304</b>	-	21748	13370	13371	13312	<b>AD205</b>	12780
<b>S1 (CH1)</b>	-	<b>M101</b>	-	-	21751	21750	16042	<b>AD101</b>	ON DEMAND
<b>S2 (CH1)</b>	15407	<b>M102</b>	-	21749 13168	13419	14287	13442	<b>AD102</b>	ON DEMAND
<b>S3 (CH2)</b>	15085	<b>M103</b>	-	14498 14109	13419	14287	13442	<b>AD103</b>	ON DEMAND
<b>S4 (CH2)</b>	-	<b>M104</b>	-	-	21751	21750	13442	<b>AD104</b>	ON DEMAND
<b>S5 (CH2)</b>	15407	<b>M105</b>	-	14706	13419	14287	13442	<b>AD105</b>	ON DEMAND
<b>ALIM (CH1)</b>	-	-	-	-	-	-	16030	<b>AD51</b>	ON DEMAND

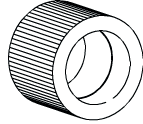

		<b>MOTOR</b>	<b>MOTOR FAN</b>	<b>MOTOR PULLEY</b>	<b>CODER CABLE</b>	<b>POWER CABLE</b>	<b>AMPLIFIER</b>	<b>AMPLIFIER FAN</b>
<b>X11 (CH1)</b>	15384	<b>M211</b>	-	14496 14116	13370	13371	16047	<b>AD201</b> ON DEMAND
<b>Y11 (CH1)</b>	15382	<b>M311</b>	-	14133	13370	13371	16048	<b>AD202</b> ON DEMAND
<b>X21 (CH1)</b>	15384	<b>M221</b>	-	14133	13370	13371	16048	<b>AD202</b> ON DEMAND
<b>Y21 (CH2)</b>	15382	<b>M321</b>	-	14133	13370	13371	16048	<b>AD202</b> ON DEMAND
<b>Z11 (CH1)</b>	15384	<b>M411</b>	-	14133	13370	13371	16047	<b>AD201</b> ON DEMAND
<b>X31 (CH2)</b>	15382	<b>M231</b>	-	14496 14116	13370	13371	16047	<b>AD203</b> ON DEMAND
<b>Z31 (CH2)</b>	15384	<b>M431</b>	-	14496 14116	13370	13371	16047	<b>AD203</b> ON DEMAND
<b>X41 (CH2)</b>	15382	<b>M241</b>	-	14496 14116	13370	13371	16048	<b>AD204</b> ON DEMAND
<b>Z41 (CH2)</b>	15384	<b>M441</b>	-	14133	13370	13371	16048	<b>AD204</b> ON DEMAND
<b>Y41 (CH2)</b>	15382	<b>M341</b>	-	21748	13370	13371	16048	<b>AD204</b> ON DEMAND
<b>S11 (CH1)</b>	-	<b>M101</b>	-	-	21751	21750	16045	<b>AD111</b> ON DEMAND
<b>S21 (CH1)</b>	15407	<b>M102</b>	-	21749 13168	13415	14287	16044	<b>AD121</b> ON DEMAND
<b>S31 (CH2)</b>	15085	<b>M103</b>	-	14498 14109	13419	14287	16044	<b>AD131</b> ON DEMAND
<b>S41 (CH2)</b>	-	<b>M104</b>	-	-	21751	21750	16044	<b>AD141</b> ON DEMAND
<b>S42 (CH2)</b>	15407	<b>M105</b>	-	14706	13415	14287	16044	<b>AD142</b> ON DEMAND
<b>ALIM (CH1)</b>	-	-	-	-	-	-	16033	<b>AD51</b> ON DEMAND



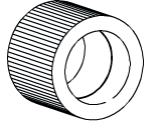

	<b>MOTOR</b>		<b>MOTOR FAN</b>	<b>MOTOR PULLEY</b>	<b>CODER CABLE</b>	<b>POWER CABLE</b>	<b>AMPLIFIER</b>		<b>AMPLIFIER FAN</b>
<b>X1 (CH1)</b>	13368	M201	-	14496 14116	13370	13371	13312	AD201	12780
<b>Y1 (CH1)</b>	13369	M301	-	14133	13370	13371	13312	AD202	12780
<b>X2 (CH1)</b>	13368	M202	-	14133	13370	13371	13312	AD202	12780
<b>Y2 (CH2)</b>	13369	M302	-	14133	13370	13371	13312	AD203	12780
<b>Z1 (CH1)</b>	13368	M401	-	14133	13370	13371	13312	AD201	12780
<b>X3 (CH2)</b>	13369	M203	-	14496 14116	13370	13371	13312	AD203	12780
<b>Z3 (CH2)</b>	13368	M403	-	14496 14116	13370	13371	13312	AD204	12780
<b>X4 (CH2)</b>	13369	M204	-	14496 14116	13370	13371	13312	AD204	12780
<b>Z4 (CH2)</b>	13368	M404	-	14133	13370	13371	13312	AD205	12780
<b>Y4 (CH2)</b>	13369	M304	-	21748	13370	13371	13312	AD205	12780
<b>S1 (CH1)</b>	-	M101	-	-	21751	21750	16039	AD101	ON DEMAND
<b>S2 (CH1)</b>	15407	M102	-	21749 13168	13419	14287	13442	AD102	ON DEMAND
<b>S3 (CH2)</b>	15085	M103	-	14498 14109	13419	14287	13442	AD103	ON DEMAND
<b>S4 (CH2)</b>	-	M104	-	-	21751	21750	16039	AD104	ON DEMAND
<b>S5 (CH2)</b>	14259	M105	-	14706	13419	14287	13442	AD105	ON DEMAND
<b>S6 (CH2)</b>	15407	M106	-	ON DEMAND	ON DEMAND	ON DEMAND	13442	AD106	ON DEMAND
<b>ALIM (CH1)</b>	-	-	-	-	-	-	16031	AD51	ON DEMAND

# MULTIDECO MD20/6, MD20/8 & MD20/8B

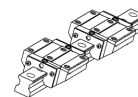
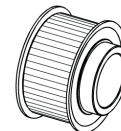

				MD20/6	MD20/8			
<b>X1</b>	13775	4 x 13349	2 x 13514	13070	13039	455 mm / 355 mm	13777	13781
<b>X2</b>	13775	4 x 13349	2 x 13514	13039	13039	355 mm	13777	13781
<b>X3</b>	13775	4 x 13349	2 x 13514	13039	13039	355 mm	13777	13781
<b>X4</b>	13775	4 x 13349	2 x 13514	13070	13070	455 mm	13777	13781
<b>X5</b>	13775	4 x 13349	2 x 13514	13070	13070	455 mm	13777	13781
<b>X6</b>	13775	4 x 13349	2 x 13514	13071	13071	720 mm	13778	13781
<b>X7</b>	13775	4 x 13349	2 x 13514	13917	13917	700 mm	13779	13781
<b>X8 (MD20/8)</b>	13775	4 x 13349	2 x 13514	-	13071	720 mm	13779	13781-13782
<b>X9 (MD20/8)</b>	13775	4 x 13349	2 x 13514	-	13917	700 mm	13779	13781-13782
<b>Z11 (MD20/6)</b>	13775	4 x 13349	2 x 13514	12989	-	500 mm	13779	13783
<b>Z12</b>	13775	4 x 13349	2 x 13514	12989	12989	500 mm	13779	13783
<b>Z13</b>	13775	4 x 13349	2 x 13514	12989	12989	500 mm	13779	13783
<b>Z14</b>	13775	4 x 13349	2 x 13514	12989	12989	500 mm	13779	13783
<b>Z15</b>	13775	4 x 13349	2 x 13514	12989	12989	500 mm	13779	13783
<b>Z16 (MD20/8)</b>	13775	4 x 13349	2 x 13514	-	12989	500 mm	13779	13783
<b>Z17 (MD20/8)</b>	13775	4 x 13349	2 x 13514	-	12989	500 mm	13779	-
<b>Z21</b>	13776	3 x 13349	13514	13049	13049	390 mm	13779	-
<b>Z22</b>	13776	3 x 13349	13514	13049	13049	390 mm	13779	-
<b>Z23</b>	13776	3 x 13349	13514	13049	13049	390 mm	13779	-
<b>Z24</b>	13776	3 x 13349	13514	13049	13049	390 mm	13779	-
<b>Z25</b>	13776	3 x 13349	13514	13049	13049	390 mm	13779	-
<b>Z26</b>	13776	3 x 13349	13514	13049	13049	390 mm	13779	-
<b>Z27 (MD20/8)</b>	13776	3 x 13349	13514	13049	13049	390 mm	13779	-
<b>Z28 (MD20/8)</b>	13776	3 x 13349	13514	13007	13007	480 mm	13780	-





		MOTOR	MOTOR FAN	MOTOR PULLEY	CODER CABLE	POWER CABLE	AMPLIFIER MD20/6		AMPLIFIER MD20/8		AMPLIFIER FAN
<b>X1</b>	13784	<b>M211</b>	-	1239	1241	1242	15355	<b>AD202</b>	15355	<b>AD202</b>	13243
<b>X2</b>	13784	<b>M222</b>	-	1239	1241	1242	15355	<b>AD203</b>	15355	<b>AD203</b>	13243
<b>X3</b>	13784	<b>M233</b>	-	1239	1241	1242	15355	<b>AD204</b>	15355	<b>AD204</b>	13243
<b>X4</b>	13784	<b>M244</b>	-	1239	1241	1242	15355	<b>AD205</b>	15355	<b>AD205</b>	13243
<b>X5</b>	13784	<b>M255</b>	-	1239	1241	1242	15355	<b>AD206</b>	15355	<b>AD206</b>	13243
<b>X6</b>	13784	<b>M266</b>	-	1239	1241	1242	15355	<b>AD207</b>	15355	<b>AD207</b>	13243
<b>X7</b>	13784	<b>M277</b>	-	1240	1241	1242	0660	<b>AD208</b>	15355	<b>AD208</b>	13243
<b>X8 (MD20/8)</b>	13784	<b>M288</b>	-	1240	1241	1242	-	-	15355	<b>AD209</b>	13243
<b>X9 (MD20/8)</b>	13784	<b>M299</b>	-	1240	1241	1242	-	-	15355	<b>AD210</b>	13243
<b>Z11 (MD20/6)</b>	13784		-	1240	1241	1242	15355		-	-	13243
<b>Z12</b>	13784	<b>M422</b>	-	1240	1241	1242	15355	<b>AD210</b>	15355	<b>AD210</b>	13243
<b>Z13</b>	13784	<b>M433</b>	-	1240	1241	1242	15355	<b>AD211</b>	15355	<b>AD211</b>	13243
<b>Z14</b>	13784	<b>M444</b>	-	1240	1241	1242	15355	<b>AD211</b>	15355	<b>AD211</b>	13243
<b>Z15</b>	13784	<b>M455</b>	-	1240	1241	1242	15352	<b>AD212</b>	15355	<b>AD212</b>	13243
<b>Z16 (MD20/8)</b>	13784	<b>M466</b>	-	1240	1241	1242	-	-	15355	<b>AD212</b>	13243
<b>Z17 (MD20/8)</b>	13784		-	1240	1241	1242	-	-	15355		13243
<b>Z21</b>	13784	<b>M311</b>	-	1240	1241	1242	15355	<b>AD202</b>	15355	<b>AD202</b>	13243
<b>Z22</b>	13784	<b>M322</b>	-	1240	1241	1242	15355	<b>AD203</b>	15355	<b>AD203</b>	13243
<b>Z23</b>	13784	<b>M333</b>	-	1240	1241	1242	15355	<b>AD204</b>	15355	<b>AD204</b>	13243
<b>Z24</b>	13784	<b>M344</b>	-	1240	1241	1242	15355	<b>AD205</b>	15355	<b>AD205</b>	13243
<b>Z25</b>	13784	<b>M355</b>	-	1240	1241	1242	15355	<b>AD206</b>	15355	<b>AD206</b>	13243
<b>Z26</b>	13784	<b>M366</b>	-	1240	1241	1242	15355	<b>AD207</b>	15355	<b>AD207</b>	13243
<b>Z27 (MD20/8)</b>	13784	<b>M377</b>	-	1240	1241	1242	-	-	15355	<b>AD208</b>	13243
<b>Z28 (MD20/8)</b>	13784	<b>M388</b>	-	1240	1241	1242	-	-	15355	<b>AD209</b>	13243
<b>ALIMENTATION</b>	-		-	-	-	-		<b>AD51</b>	15401	<b>AD51</b>	
<b>ALIMENTATION</b>	-		-	-	-	-	15401	<b>AD52</b>	15401	<b>AD52</b>	13252
<b>ALIMENTATION</b>	-		-	-	-	-	15401	<b>AD53</b>	15401	<b>AD53</b>	13252
<b>S1</b>	1246	<b>M101</b>	-	ON DEMAND	ON DEMAND	ON DEMAND	ON DEMAND	<b>AD101</b>	1244	<b>AD101</b>	
<b>S2</b>	1247	<b>M102</b>	12809	ON DEMAND	ON DEMAND	ON DEMAND	ON DEMAND	<b>AD102</b>	15340	<b>AD102</b>	13243
<b>S3</b>	1247	<b>M103</b>	12809	ON DEMAND	ON DEMAND	ON DEMAND	ON DEMAND	<b>AD103</b>	15340	<b>AD103</b>	13243
<b>S4</b>	14995	<b>M104</b>	12809	ON DEMAND	ON DEMAND	ON DEMAND	ON DEMAND	<b>AD104</b>	15340	<b>AD104</b>	13243
<b>Arbre à came</b>	1249	<b>M501</b>	-	-	-	-	-	<b>AD201</b>	1245	<b>AD201</b>	



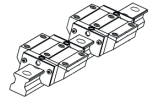
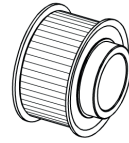
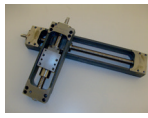

<b>X1</b>	13403	4 x 13349	2 x 13514	13049	390 mm	13791	13788
<b>X2</b>	13403	4 x 13349	2 x 13514	13049	390 mm	13791	13788
<b>X3</b>	13403	4 x 13349	2 x 13514	13049	390 mm	13791	13788
<b>X4</b>	13403	4 x 13349	2 x 13514	13049	390 mm	13791	13788
<b>X5</b>	13403	4 x 13349	2 x 13514	13049	390 mm	13791	13788
<b>X6</b>	13785	4 x 13349	2 x 13514	13049	390 mm	13792	13789
<b>X7</b>	13785	4 x 13349	2 x 13514	13049	390 mm	13792	13789
<b>Z12</b>	13786	4 x 13349	2 x 13514	13069	510 mm	13791	13790
<b>Z13</b>	13786	4 x 13349	2 x 13514	13069	510 mm	13791	13790
<b>Z14</b>	13786	4 x 13349	2 x 13514	13069	510 mm	13791	13790
<b>Z15</b>	13786	4 x 13349	2 x 13514	13069	510 mm	13791	13790
<b>Z21</b>	13787	3 x 13349	13514	13049	390 mm	13791	-
<b>Z22</b>	13787	3 x 13349	13514	13049	390 mm	13791	-
<b>Z23</b>	13787	3 x 13349	13514	13049	390 mm	13791	-
<b>Z24</b>	13787	3 x 13349	13514	13049	390 mm	13791	-
<b>Z25</b>	13787	3 x 13349	13514	13049	390 mm	13791	-
<b>Z26</b>	13787	3 x 13349	13514		390 mm	13791	-



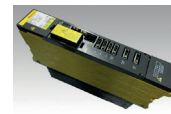
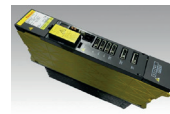

	MOTOR	MOTOR FAN	MOTOR PULLEY	CODER CABLE	POWER CABLE	AMPLIFIER -> janv 01	AMPLIFIER fev 01 ->	AMPLIFIER FAN
<b>X1</b>	13342 <b>M211</b>	-	ON DEMAND	ON DEMAND	ON DEMAND	15355 <b>AD202</b>	15343 <b>AD202</b>	13243 / 2 x 13243
<b>X2</b>	13341 <b>M222</b>	-	ON DEMAND	ON DEMAND	ON DEMAND	15355 <b>AD203</b>	15343 <b>AD203</b>	13243 / 2 x 13243
<b>X3</b>	13342 <b>M233</b>	-	ON DEMAND	ON DEMAND	ON DEMAND	15355 <b>AD204</b>	15343 <b>AD204</b>	13243 / 2 x 13243
<b>X4</b>	13342 <b>M244</b>	-	ON DEMAND	ON DEMAND	ON DEMAND	15355 <b>AD205</b>	15343 <b>AD205</b>	13243 / 2 x 13243
<b>X5</b>	13342 <b>M255</b>	-	ON DEMAND	ON DEMAND	ON DEMAND	15355 <b>AD206</b>	15343 <b>AD206</b>	13243 / 2 x 13243
<b>X6</b>	13342 <b>M266</b>	-	ON DEMAND	ON DEMAND	ON DEMAND	15355 <b>AD207</b>	15343 <b>AD207</b>	13243 / 2 x 13243
<b>X7</b>	13342 <b>M277</b>	-	ON DEMAND	ON DEMAND	ON DEMAND	15352 <b>AD208</b>	14290 <b>AD208</b>	13243 / 2 x 13243
<b>Z12</b>	13341 <b>M422</b>	-	ON DEMAND	ON DEMAND	ON DEMAND	15355 <b>AD215</b>	15343 <b>AD215</b>	13243 / 2 x 13243
<b>Z13</b>	13341 <b>M433</b>	-	ON DEMAND	ON DEMAND	ON DEMAND	15355 <b>AD215</b>	15343 <b>AD215</b>	13243 / 2 x 13243
<b>Z14</b>	13341 <b>M444</b>	-	ON DEMAND	ON DEMAND	ON DEMAND	15355 <b>AD216</b>	15343 <b>AD216</b>	13243 / 2 x 13243
<b>Z15</b>	13341 <b>M455</b>	-	ON DEMAND	ON DEMAND	ON DEMAND	15355 <b>AD216</b>	15343 <b>AD216</b>	13243 / 2 x 13243
<b>Z21</b>	13341 <b>M311</b>	-	ON DEMAND	ON DEMAND	ON DEMAND	15355 <b>AD202</b>	15343 <b>AD202</b>	13243 / 2 x 13243
<b>Z22</b>	13341 <b>M322</b>	-	ON DEMAND	ON DEMAND	ON DEMAND	15355 <b>AD203</b>	15343 <b>AD203</b>	13243 / 2 x 13243
<b>Z23</b>	13341 <b>M333</b>	-	ON DEMAND	ON DEMAND	ON DEMAND	15355 <b>AD204</b>	15343 <b>AD204</b>	13243 / 2 x 13243
<b>Z24</b>	13341 <b>M344</b>	-	ON DEMAND	ON DEMAND	ON DEMAND	15355 <b>AD205</b>	15343 <b>AD205</b>	13243 / 2 x 13243
<b>Z25</b>	13341 <b>M355</b>	-	ON DEMAND	ON DEMAND	ON DEMAND	15355 <b>AD206</b>	15343 <b>AD206</b>	13243 / 2 x 13243
<b>Z26</b>	13341 <b>M366</b>	-	ON DEMAND	ON DEMAND	ON DEMAND	15355 <b>AD207</b>	15343 <b>AD207</b>	13243 / 2 x 13243
<b>ALIMENTATION</b>	-	-	-	-	-	ON DEMAND <b>AD51</b>	ON DEMAND <b>AD51</b>	ON DEMAND
<b>ALIMENTATION</b>	-	-	-	-	-	ON DEMAND <b>AD52</b>	ON DEMAND <b>AD52</b>	ON DEMAND
<b>ALIMENTATION</b>	-	-	-	-	-	15401 <b>AD53</b>	15401 <b>AD53</b>	13252
<b>S1</b>	ON DEMAND <b>M101</b>	ON DEMAND	ON DEMAND	ON DEMAND	ON DEMAND	ON DEMAND <b>AD101</b>	ON DEMAND <b>AD101</b>	ON DEMAND
<b>S2</b>	ON DEMAND <b>M102</b>	ON DEMAND	ON DEMAND	ON DEMAND	ON DEMAND	15340 <b>AD102</b>	15340 <b>AD102</b>	13243
<b>S3</b>	ON DEMAND <b>M103</b>	ON DEMAND	ON DEMAND	ON DEMAND	ON DEMAND	15340 <b>AD103</b>	15340 <b>AD103</b>	13243
<b>S4</b>	ON DEMAND <b>M104</b>	ON DEMAND	ON DEMAND	ON DEMAND	ON DEMAND	15340 <b>AD104</b>	15340 <b>AD104</b>	13243
<b>S5</b>	ON DEMAND <b>M105</b>	ON DEMAND	ON DEMAND	ON DEMAND	ON DEMAND	ON DEMAND <b>AD105</b>	ON DEMAND <b>AD105</b>	ON DEMAND
<b>S6</b>	ON DEMAND <b>M106</b>	ON DEMAND	ON DEMAND	ON DEMAND	ON DEMAND	ON DEMAND <b>AD106</b>	ON DEMAND <b>AD106</b>	ON DEMAND
<b>Arbre à came</b>	ON DEMAND <b>M501</b>	ON DEMAND	ON DEMAND	ON DEMAND	ON DEMAND	ON DEMAND <b>AD201</b>	ON DEMAND <b>AD201</b>	ON DEMAND

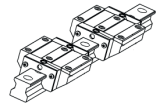
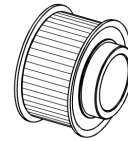
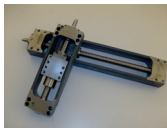

<b>X1</b>	13403	4 x 13349	2 x 13514	13007	<b>480 mm</b>	13791	13788
<b>X2</b>	13403	4 x 13349	2 x 13514	13069	<b>510 mm</b>	13791	13788
<b>X3</b>	13403	4 x 13349	2 x 13514	13069	<b>510 mm</b>	13791	13788
<b>X4</b>	13403	4 x 13349	2 x 13514	13069	<b>510 mm</b>	13791	13788
<b>X5</b>	13403	4 x 13349	2 x 13514	13069	<b>510 mm</b>	13791	13788
<b>X6</b>	13785	4 x 13349	2 x 13514	13049	<b>390 mm</b>	13792	13789
<b>X7</b>	13785	4 x 13349	2 x 13514	13049	<b>390 mm</b>	13792	13789
<b>Z11</b>	13786	4 x 13349	2 x 13514	12990	<b>630 mm</b>	13794	13790
<b>Z12</b>	13786	4 x 13349	2 x 13514	12990	<b>630 mm</b>	13794	13790
<b>Z13</b>	13786	4 x 13349	2 x 13514	12990	<b>630 mm</b>	13794	13790
<b>Z14</b>	13786	4 x 13349	2 x 13514	12990	<b>630 mm</b>	13794	13790
<b>Z15</b>	13786	4 x 13349	2 x 13514	12990	<b>630 mm</b>	13794	13790
<b>Z21</b>	13787	3 x 13349	13514	13049	<b>390 mm</b>	13791	-
<b>Z22</b>	13787	3 x 13349	13514	13049	<b>390 mm</b>	13791	-
<b>Z23</b>	13787	3 x 13349	13514	13049	<b>390 mm</b>	13791	-
<b>Z24</b>	13787	3 x 13349	13514	13049	<b>390 mm</b>	13791	-
<b>Z25</b>	13787	3 x 13349	13514	13049	<b>390 mm</b>	13791	-
<b>Z26</b>	13787	3 x 13349	13514	13007	<b>480 mm</b>	13780	-



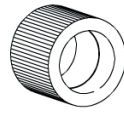

		<b>MOTOR</b>	<b>MOTOR FAN</b>	<b>MOTOR PULLEY</b>	<b>CODER CABLE</b>	<b>POWER CABLE</b>		<b>AMPLIFIER</b>	<b>AMPLIFIER FAN</b>
<b>X1</b>	13369	<b>M211</b>	-	ON DEMAND	ON DEMAND	ON DEMAND	13367	<b>AD202</b>	12780
<b>X2</b>	13369	<b>M222</b>	-	ON DEMAND	ON DEMAND	ON DEMAND	13367	<b>AD203</b>	12780
<b>X3</b>	13369	<b>M233</b>	-	ON DEMAND	ON DEMAND	ON DEMAND	13367	<b>AD209</b>	12780
<b>X4</b>	13369	<b>M244</b>	-	ON DEMAND	ON DEMAND	ON DEMAND	13367	<b>AD204</b>	12780
<b>X5</b>	13369	<b>M255</b>	-	ON DEMAND	ON DEMAND	ON DEMAND	13367	<b>AD205</b>	12780
<b>X6</b>	13369	<b>M266</b>	-	ON DEMAND	ON DEMAND	ON DEMAND	13367	<b>AD206</b>	12780
<b>X7</b>	13369	<b>M277</b>	-	ON DEMAND	ON DEMAND	ON DEMAND	13367	<b>AD210</b>	12780
<b>Z11</b>	13368	<b>M411</b>	-	ON DEMAND	ON DEMAND	ON DEMAND	13367	<b>AD210</b>	12780
<b>Z12</b>	13368	<b>M422</b>	-	ON DEMAND	ON DEMAND	ON DEMAND	13367	<b>AD207</b>	12780
<b>Z13</b>	13368	<b>M433</b>	-	ON DEMAND	ON DEMAND	ON DEMAND	13367	<b>AD207</b>	12780
<b>Z14</b>	13368	<b>M444</b>	-	ON DEMAND	ON DEMAND	ON DEMAND	13367	<b>AD208</b>	12780
<b>Z15</b>	13368	<b>M455</b>	-	ON DEMAND	ON DEMAND	ON DEMAND	13367	<b>AD208</b>	12780
<b>Z21</b>	13368	<b>M311</b>	-	ON DEMAND	ON DEMAND	ON DEMAND	13367	<b>AD202</b>	12780
<b>Z22</b>	13368	<b>M322</b>	-	-	ON DEMAND	ON DEMAND	13367	<b>AD203</b>	12780
<b>Z23</b>	13368	<b>M333</b>	-	ON DEMAND	ON DEMAND	ON DEMAND	13367	<b>AD209</b>	12780
<b>Z24</b>	13368	<b>M344</b>	-	ON DEMAND	ON DEMAND	ON DEMAND	13367	<b>AD204</b>	12780
<b>Z25</b>	13368	<b>M355</b>	-	ON DEMAND	ON DEMAND	ON DEMAND	13367	<b>AD205</b>	12780
<b>Z26</b>	13368	<b>M366</b>	-	ON DEMAND	ON DEMAND	ON DEMAND	13367	<b>AD206</b>	12780
<b>ALIMENTATION</b>	-	-	-	-	-	-	ON DEMAND	<b>AD51</b>	ON DEMAND
<b>ALIMENTATION</b>	-	-	-	-	-	-	ON DEMAND	<b>AD52</b>	ON DEMAND
<b>ALIMENTATION</b>	-	-	-	-	-	-	15362	<b>AD53</b>	13249 / 14158
<b>S1</b>	ON DEMAND	<b>M101</b>	ON DEMAND	ON DEMAND	ON DEMAND	ON DEMAND	ON DEMAND	<b>AD101</b>	ON DEMAND
<b>S2</b>	ON DEMAND	<b>M102</b>	ON DEMAND	ON DEMAND	ON DEMAND	ON DEMAND	ON DEMAND	<b>AD102</b>	ON DEMAND
<b>S3</b>	ON DEMAND	<b>M103</b>	ON DEMAND	ON DEMAND	ON DEMAND	ON DEMAND	ON DEMAND	<b>AD103</b>	ON DEMAND
<b>S4</b>	14764	<b>M104</b>	ON DEMAND	ON DEMAND	ON DEMAND	ON DEMAND	ON DEMAND	<b>AD104</b>	ON DEMAND
<b>S5</b>	ON DEMAND	<b>M105</b>	ON DEMAND	ON DEMAND	ON DEMAND	ON DEMAND	ON DEMAND	<b>AD105</b>	ON DEMAND
<b>S6</b>	ON DEMAND	<b>M106</b>	ON DEMAND	ON DEMAND	ON DEMAND	ON DEMAND	ON DEMAND	<b>AD106</b>	ON DEMAND
<b>Arbre à came</b>	ON DEMAND	<b>M501</b>	ON DEMAND	ON DEMAND	ON DEMAND	ON DEMAND	ON DEMAND	<b>Ad201</b>	ON DEMAND

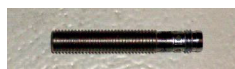

**Câble 5m conn droit**

**Câble 5m conn coudé**

**Sonde M8 - 55 mm**

**Sonde universelle**

12766

12767

13225

12799

**Prise mâle / Stecker**

**Prise mâle / Stecker**

12768

12768

## PNEUMATICS



Type/Typ	Ø Ext./Auss.	Ø Int./Innen.	N° DST
PUN-4x0,75-DUO-BS	4	2,60	<b>13171</b>
PUN-6x1-DUO-BS	6	4,00	<b>13605</b>
PUN-8x1,25-DUO-BS	8	5,70	<b>13606</b>



Type/Typ	Ø Ext./Auss.	Ø Int./Innen.	N° DST
PUN-4x0,75-BL	4,0	2,60	<b>13607</b>
PUN-6x1-BL	6,0	4,00	<b>13155</b>
PUN-8x1,25-BL	8,0	5,70	<b>13608</b>
PUN-10x1,5-BL	10,0	7,00	<b>13967</b>



Type/Typ	Ø Ext./Auss.	N° DST
PAN-R 8x1.5	8	<b>14328</b>
PAN-R 10x1.9	10	<b>14329</b>
PAN-R 12x2.2	12	<b>14330</b>
PAN-R 16x3	16	<b>14331</b>





Type/Typ	Racc./Verbind.	Ø Tuyau/Schlauch	N° DST
QS-1/8-4	R1/8	4,00	<b>13609</b>
QS-1/8-6	R1/8	6,00	<b>13609</b>
QS-1/8-8	R1/8	8,00	<b>21044</b>
QS-1/4-6	R1/4	6,00	<b>13968</b>
QS-1/4-8	R1/4	8,00	<b>13969</b>
QS-1/4-10	R1/4	10,00	<b>13612</b>
QS-3/8-8	R3/8	8,00	<b>13970</b>
QS-3/8-10	R3/8	10,00	<b>13971</b>



Type/Typ	Ø Tuyau/Schlauch A	Ø Tuyau/Schlauch B	N° DST
QS-4	4,00	4,00	<b>1361300</b>
QS-6	6,00	6,00	<b>13614</b>
QS-8	8,00	8,00	<b>13972</b>
QS-10	10,00	10,00	<b>13973</b>
QS-6-4	6,00	4,00	<b>13615</b>
QS-8-6	8,00	6,00	<b>13616</b>
QS-10-8	10,00	8,00	<b>13617</b>



Type/Typ	Ø Tuyau/Schlauch	Ø Racc./Verbind.	N° DST
QS-6H-4	4,00	6,00	<b>13618</b>
QS-8H-6	6,00	8,00	<b>13619</b>
QS-10H-8	8,00	10,00	<b>13974</b>



Type/Typ	Ø Tuyau/Schlauch A	Ø Tuyau/Schlauch B	N° DST
QSL-4	4,00	4,00	<b>15160</b>
QSL-6	6,00	6,00	<b>13620</b>
QSL-8	8,00	8,00	<b>13621</b>
QSL-10	10,00	10,00	<b>13984</b>



Type/Typ	Ø Tuyau/Schlauch	Ø Racc./Verbind.	N° DST
QSL-4H	4,00	4,00	<b>13992</b>
QSL-6H	6,00	6,00	<b>13623</b>
QSL-8H	8,00	8,00	<b>13993</b>
QSL-10H	10,00	10,00	<b>13624</b>
QSL-6H-4	6,00	4,00	<b>13994</b>
QSL-8H-6	8,00	6,00	<b>13995</b>
QSL-10H-8	10,00	8,00	<b>13996</b>



Type/Typ	Ø Racc./Verbind.	Ø Tuyau/Schlauch	N° DST
QSLV2-1/8-4	R1/8	4,00	<b>13997</b>
QSLV2-1/8-6	R1/8	6,00	<b>13625</b>
QSLV2-1/8-8	R1/8	8,00	<b>13626</b>
QSLV2-1/4-6	R1/4	6,00	<b>13627</b>
QSLV2-1/4-8	R1/4	8,00	<b>13998</b>
QSLV2-1/4-10	R1/4	10,00	<b>13628</b>
QSLV2-3/8-8	R3/8	8,00	<b>13999</b>
QSLV2-3/8-10	R3/8	10,00	<b>14000</b>





Type/Typ	Racc./Verbind.	Ø Tuyau/Schlauch	N° DST
QSF-1/8-4-B	G1/8	4,00	<b>13975</b>
QSF-1/8-6-B	G1/8	6,00	<b>13976</b>
QSF-1/8-8-B	G1/8	8,00	<b>13977</b>
QSF-1/4-6-B	G1/4	6,00	<b>13978</b>
QSF-1/4-8-B	G1/4	8,00	<b>13979</b>
QSF-1/4-10-B	G1/4	10,00	<b>13980</b>
QSF-3/8-8-B	G3/8	8,00	<b>13981</b>
QSF-3/8-10-B	G3/8	10,00	<b>13982</b>



Type/Typ	Racc./Verbind.	Ø Tuyau/Schlauch	N° DST
QSMF-M5-4	M5	4,00	<b>14001</b>



Type/Typ	Ø Racc./Verbind.	Ø Tuyau/Schlauch	N° DST
QSL-1/8-4	R1/8	4,00	<b>13985</b>
QSL-1/8-6	R1/8	6,00	<b>13986</b>
QSL-1/8-8	R1/8	8,00	<b>13987</b>
QSL-1/4-6	R1/4	6,00	<b>13988</b>
QSL-1/4-8	R1/4	8,00	<b>13989</b>
QSL-1/4-10	R1/4	10,00	<b>13622</b>
QSL-3/8-8	R3/8	8,00	<b>13990</b>
QSL-3/8-10	R3/8	10,00	<b>13991</b>
QSL-3/8-16	R3/8	16,00	<b>14122</b>





Type/Typ	Ø Tuyau/Schlauch	N° DST
QSC-4	4,00	<b>14004</b>
QSC-6	6,00	<b>14005</b>
QSC-8	8,00	<b>14006</b>
QSC-10	10,00	<b>14007</b>



Type/Typ	Ø Tuyau/Schlauch	N° DST
QST-4	4,00	<b>14324</b>
QST-6	6,00	<b>14325</b>
QST-8	8,00	<b>14326</b>
QST-10	10,00	<b>14327</b>



Type/Typ	Ø Tuyau/ Schlauch A	Ø Tuyau/ Schlauch B	Ø Ext./Auss.	N° DST
QSS-4	4,00	4,00	M12	<b>14002</b>
QSS-6	6,00	6,00	M14	<b>13629</b>
QSS-8	8,00	8,00	M16	<b>21645</b>
QSS-10	10,00	10,00	M20	<b>14003</b>



Type/Typ	Ø Racc./Verbind.	N° DST
QSC-4H	4,00	<b>13630</b>
QSC-6H	6,00	<b>13631</b>
QSC-8H	8,00	<b>13632</b>
QSC-10H	10,00	<b>14008</b>





Type/Typ	Ø Racc./Verbind. A	Ø Racc./Verbind. B	N° DST
QSH-4	4,00	4,00	<b>14009</b>
QSH-6	6,00	6,00	<b>13633</b>
QSH-8	8,00	8,00	<b>14010</b>
QSH-10	10,00	10,00	<b>14011</b>



Type/Typ	Ø Racc./Verbind.	Ø Tuyau/Schlauch	N° DST
QSLF-1/8-4B	G1/8	4,00	<b>14012</b>
QSLF-1/8-6B	G1/8	6,00	<b>14013</b>
QSLF-1/8-8B	G1/8	8,00	<b>14014</b>
QSLF-1/4-6B	G1/4	6,00	<b>14015</b>
QSLF-1/4-8B	G1/4	8,00	<b>14016</b>
QSLF-1/4-10B	G1/4	10,00	<b>14017</b>
QSLF-3/8-8B	G3/8	8,00	<b>14018</b>
QSLF-3/8-10B	G3/8	10,00	<b>14019</b>



Type/Typ	Racc./Verbind.	Ø Tuyau/Schlauch	N° DST
QSMML-M5-4	M5	4,00	14022
QSMF-M5-6	M5	6,00	14023
QSMF-M3-4	M3	4,00	16021



Type/Typ	Ø Racc./Verbind.	Ø Tuyau/Schlauch	Ø Ext./Auss.	N° DST
QSSF-1/8-4-B	G1/8	4,00	M12	<b>14024</b>
QSSF-1/8-6-B	G1/8	6,00	M14	<b>14025</b>
QSSF-1/8-8-B	G1/8	8,00	M16	<b>14026</b>
QSSF-1/4-6-B	G1/4	6,00	M14	<b>14027</b>
QSSF-1/4-8-B	G1/4	8,00	M16	<b>14028</b>
QSSF-1/4-10-B	G1/4	10,00	M20	<b>14029</b>
QSSF-3/8-8-B	G3/8	8,00	M16	<b>14030</b>
QSSF-3/8-10-B	G3/8	10,00	M20	<b>14031</b>



Type/Typ	Racc./Verbind.	Ø Tuyau/Schlauch	N° DST
QSM-M5-4	M5	4,00	<b>14020</b>
QSM-M5-6	M5	6,00	<b>14021</b>

GRLA-....-QS-....-RS-D



Type/Typ	Ø Racc./Verbind.	Ø Tuyau/Schlauch	N° DST
GRLA-M5-QS-4-RS-D	M5	4,00	<b>13634</b>
GRLA-M5-QS-6-RS-D	M5	6,00	<b>14032</b>
GRLA-1/8-QS-4-RS-D	G1/8	4,00	<b>13190</b>
GRLA-1/8-QS-6-RS-D	G1/8	6,00	<b>13170</b>
GRLA-1/8-QS-8-RS-B	G1/8	8,00	<b>14033</b>
GRLA-1/4-QS-6-RS-B	G1/4	6,00	<b>14034</b>
GRLA-1/4-QS-8-RS-B	G1/4	8,00	<b>14035</b>
GRLA-3/8-QS-6-RS-B	G3/8	6,00	<b>21646</b>
GRLA-3/8-QS-8-RS-B	G3/8	8,00	<b>14037</b>

GRLA-....-QS-....-RS-B



Type/Typ	Ø Racc./Verbind.	Matière/Material	N° DST
B-M5	M5	Alu	<b>13635</b>
B-1/8	G1/8	Acier/Stahl	<b>13636</b>
B-1/4	G1/4	Acier/Stahl	<b>13637</b>
B-3/8	G3/8	Acier/Stahl	<b>14038</b>
B-1/2	G1/2	Acier/Stahl	<b>14039</b>



Type/Typ	Ø Racc./Verbind.	Long/Länge	N° DST
D-M5I-1/8	M5 / G1/8	11,00 / 7,50	<b>13638</b>
D-M5I-1/4	M5 / G1/4		<b>14040</b>
D-1/8I-1/4	G1/8 / G1/4	11,00 / 7,00	<b>13639</b>
D-1/4I-1/8	G1/4 / G1/8	15,00 / 11,00	<b>16036</b>
D-1/4I-1/2	G1/4 / G1/2		<b>14041</b>
D-3/8I-1/2	G3/8 / G1/2	18,00 / 12,00	<b>14042</b>





Type/Typ	Ø Racc./ Verbind. A	Ø Racc./ Verbind.	Mat/Material	N° DST
E-M5-M5	M5	M5	Acier/Stahl	<b>14043</b>
E-M5-1/8	M5	G1/8	Acier/Stahl	<b>14044</b>
E-1/8-1/8-MS	G1/8	G1/8	Laiton/Messing	<b>14045</b>
E-1/8-1/4-MS	G1/8	G1/4	Laiton/Messing	<b>14046</b>
E-1/4-1/4-MS	G1/4	G1/4	Laiton/Messing	<b>14047</b>
E-1/4-3/8-MS	G1/4	G3/8	Laiton/Messing	<b>14048</b>
E-3/8-3/8-MS	G3/8	G3/8	Laiton/Messing	<b>14049</b>
E-3/8-1/2-MS	G3/8	G1/2	Laiton/Messing	<b>14050</b>
E-1/2-1/2-MS	G1/2	G1/2	Laiton/Messing	<b>14051</b>



Type/Typ	Ø Racc./ Verbind. A	Ø Racc./ Verbind.	Mat/Material	N° DST
E-M5-M5	M5	M5	Acier/Stahl	<b>14043</b>
E-M5-1/8	M5	G1/8	Acier/Stahl	<b>14044</b>
E-1/8-1/8-MS	G1/8	G1/8	Laiton/Messing	<b>14045</b>
E-1/8-1/4-MS	G1/8	G1/4	Laiton/Messing	<b>14046</b>
E-1/4-1/4-MS	G1/4	G1/4	Laiton/Messing	<b>14047</b>
E-1/4-3/8-MS	G1/4	G3/8	Laiton/Messing	<b>14048</b>
E-3/8-3/8-MS	G3/8	G3/8	Laiton/Messing	<b>14049</b>
E-3/8-1/2-MS	G3/8	G1/2	Laiton/Messing	<b>14050</b>
E-1/2-1/2-MS	G1/2	G1/2	Laiton/Messing	<b>14051</b>



Type/Typ	Ø Racc./ Verbind.	Mat/Material	N° DST
FR-M5-A/I	M5	Alu	<b>14052</b>
FR-1/8-A/I	G1/8	Alu	<b>14053</b>
FR-1/4-A/I	G1/4	Alu	<b>14054</b>
FR-3/8-A/I	G3/8	Alu	<b>14055</b>
FR-1/2-I/I	G1/2	Laiton/Messing	<b>14056</b>





Type/Typ	Ø Racc./ Verbind.	Mat/Material	N° DST
NPFC-L-2M5-F	M5	Alu	<b>14057</b>
NPFC-L-2G18-F	G1/8	Alu	<b>14058</b>
NPFC-L-2G14-F	G1/4	Alu	<b>14059</b>
NPFC-L-2G38-F	G3/8	Alu	<b>14060</b>
NPFC-L-2G12-F	G1/2	Alu	<b>14061</b>



Type/Typ	Ø Racc./ Verbind.	N° DST
GRE-1/8	G1/8	<b>14062</b>
GRE-1/4	G1/4	<b>14063</b>



Type/Typ	Ø Int./Innen.	Ø Ext./Auss.	Ep./Dicke	N° DST
O-M5	5,10	8,00	1,00	<b>14071</b>
O-1/8	10,00	13,00	1,50	<b>14072</b>
O-1/4	13,20	18,00	2,00	<b>14074</b>
O-3/8	16,80	22,00	2,00	<b>14075</b>
O-1/2	21,00	28,00	2,00	<b>14076</b>



Type/Typ	Ø Racc./ Verbind.	Long./Länge	N° DST
QM-M5-M5	M5	12,00	<b>14077</b>
QM-1/8-1/8	G1/8	22,00	<b>14078</b>
QM-1/4-1/4	G1/4	26,00	<b>14079</b>
QM-3/8-3/8	G3/8	32,00	<b>14080</b>
QM-1/2-1/2	G1/2	36,00	<b>14081</b>





Type/Typ	Ø Racc./ Verbind.	Ø tuyau/ Schlauch	N° DST
QSL-F ¼ – 6	¼	6	<b>14332</b>
QSL-F ¼ – 8	¼	8	<b>14333</b>
QSL-F ¼ – 10	¼	10	<b>14334</b>
QSL-F 3/8 – 10	3/8	10	<b>14335</b>
QSL-F 3/8 – 12	3/8	12	<b>14336</b>



Type/Typ	Ø Racc./ Verbind.	Ø Filetage	Long./Länge	N° DST
SCM-M5	M5	M10x1	15,00	<b>14082</b>
SCM-1/8	G1/8	M14x1,5	22,00	<b>14083</b>
SCM-1/4	G1/4	M20x1,5	24,00	<b>14084</b>
SCM-3/8	G3/8	M24x1,5	27,00	<b>14085</b>
SCM-1/2	G1/2	M30x1,5	36,00	<b>14086</b>



Type/Typ	Ø Racc.Int/ Verbind. Innen	Ø Racc.Ext/ Aus.Verbind	N° DST
TJK-1/8	G1/8	G1/8	<b>14087</b>
TJK-1/4	G1/4	G1/4	<b>14088</b>
TJK-3/8	G3/8	G3/8	<b>14089</b>
TJK-1/2	G1/2	G1/2	<b>14090</b>



Type/Typ	Ø Racc./ Verbind.	N° DST
U-1/8	G1/8	<b>12759</b>
U-1/4	G1/4	<b>13004</b>



Type/Typ	Ø Tuyau/ Schlauch A	Ø Tuyau/ Schlauch B	N° DST
H-QS-4	4,00	4,00	<b>12891</b>
H-QS-6	6,00	6,00	<b>12888</b>
H-QS-8	8,00	8,00	<b>12889</b>
H-QS-10	10,00	10,00	<b>12890</b>



Type/Typ	Ø Tuyau/ Schlauch A	Ø Tuyau/ Schlauch B	N° DST
LRMA-QS-4	4,00	4,00	<b>21886</b>
LRMA-QS-6	6,00	6,00	<b>21887</b>



Type/Typ	Ø Racc./ Verbind.	Ø pour/ für Banjo	N° Banjo	N° DST
VT-1/8-2	G1/8	G1/8	2	<b>21660</b>
VT-1/8-3	G1/8	G1/8	3	<b>21661</b>
VT-1/4-2-1/4	G1/4	G1/4	2	<b>21662</b>
VT-1/4-3-1/4	G1/4	G1/4	3	<b>21663</b>
VT-3/8-2-3/8	G3/8	G3/8	2	<b>21664</b>
VT-3/8-3-3/8	G3/8	G3/8	3	<b>21665</b>



Type/Typ	Ø Racc./ Verbind.	N° DST
LK-1/8	G1/8	<b>21657</b>
LK-1/4	G1/4	<b>21658</b>
LK-3/8	G3/8	<b>21659</b>



Type/Typ	Ø Racc./ Verbind.	N° DST
TK-1/8	G1/8	<b>21654</b>
TK-1/4	G1/4	<b>21655</b>
TK-3/8	G3/8	<b>21656</b>

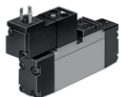

Type/Typ	N° DST
MN2H-5/2-D-02-FR	<b>13204</b>



Type/Typ	N° DST
KMEB-1-24-5-LED	<b>13327</b>



Type/Typ	N° DST
MN2H-5/3E-D-02	<b>13205</b>



Type/Typ	N° DST
KMEB-1-24-5-LED	<b>13327</b>



Type/Typ	N° DST
MFH-5-PK-3	<b>12878</b>



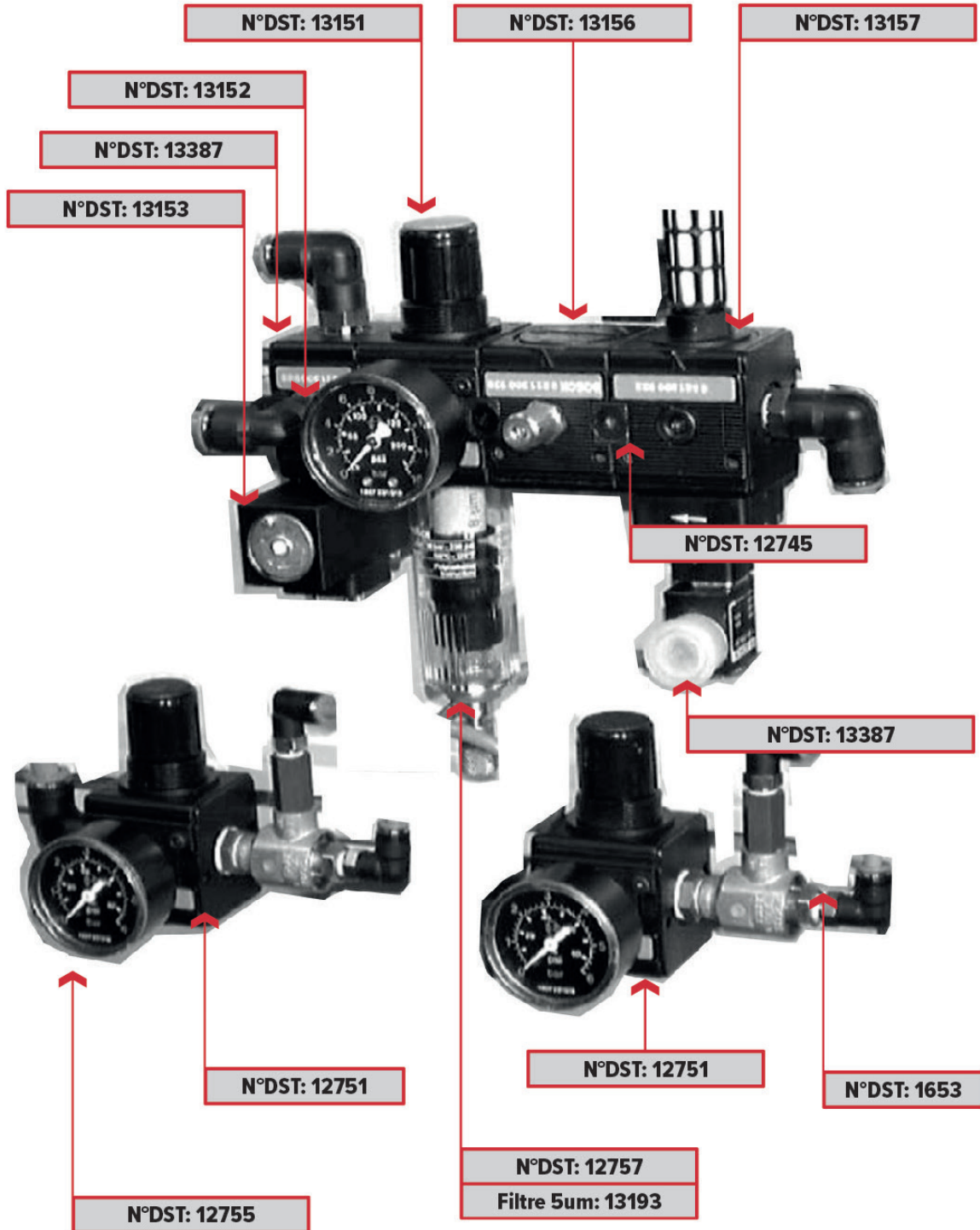



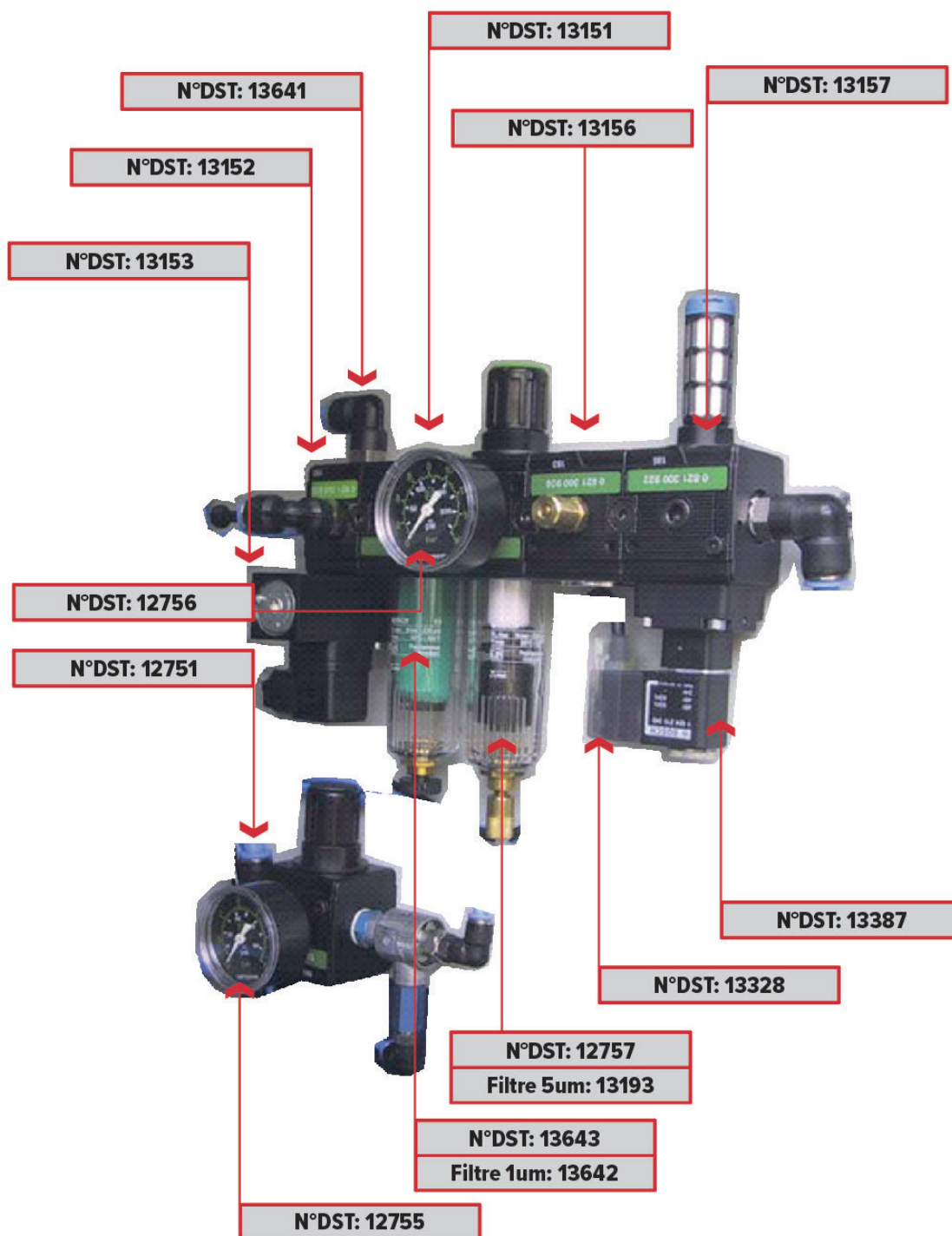

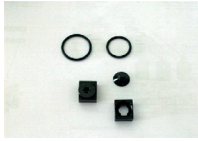

Eléments de liaison NL2 /  
Verbindung NL2

**N° DST  
12745**



Jeu d'étanchéité / Dichtungen

**N° DST  
12753**

**PNEUMATIC NEW VERSION**



Deco

**N° DST  
15474**

Micro

**N° DST  
21017**

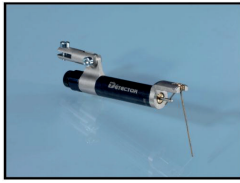

## KIT Minidetector Type 202

N°DST  
13554



### Description

N° DST

Tube coaxial

12883



### Description

N° DST

Y de dérivation

12882



### Description

N° DST

Tige de palpation dur long 60 (lot de 10)

14105

Tige de palpation dur long 80 (lot de 10)

14106



### Description

N° DST

Joint torique

12884



### Description

N° DST

Presse étoupe

14107



### Description

N° DST

Noix de serrage à molette

14108



### Description

N° DST

Pressostat standard (détection dès 1 bar)

12885



**N° DST**



**13484**

**Machines :**  
Deco13  
Deco20



**14229**

**Machines :**  
Deco10a  
Deco13a  
Deco20a

**13909**

**Machine :**  
Deco10 old versions



**13918**

**Machines**  
Sigma 20  
Sigma 32



**13932**

**Machines :**  
Micro8  
Sigma 8

**13933**

**Machines**  
Evodeco



**13934**

**Machines**  
Deco H1, spécial

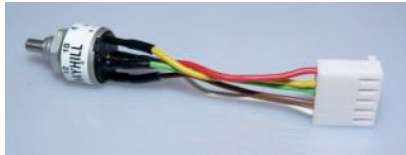

**13353**

Potentiometer cooling



**15107**

Ensemble de 3 sélecteurs OLD



**13347**

12 positions with cable

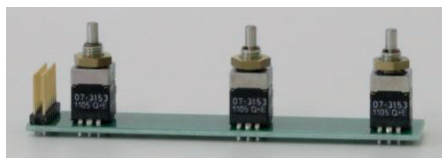

**15187**

Ensemble de 3 sélecteurs / Sigma 20

## ***HIGH FREQUENCY SPINDLE***



**Description**

**N° DST**

Broche diamètre 22 mm

**15024**



**Description**

**N° DST**

Broche diamètre 25 mm

**15023**



**Description**

**N° DST**

Convertisseur de fréquence 2 sorties

**15025**



Description	N° DST
Unité de conditionnement 4 bars	<b>15026</b>
Huile de lubrification	<b>15027</b>
Prise de communication subcon	<b>15029</b>
Boitier pour 2 convertisseurs	<b>14679</b>
Rallonge air+subcon	<b>15049 - 15062</b>

**LED**



LED 700 mm : N° : 15463	LED 370 mm : N° : 15157	LED : N° : 15098
Cable : N° : 15158	Cable : N° : 15158	
Fix orient. : N° : 14874	Fix fixe : N° : 15159	
Fix fixe : N° : 14875		

## Deco 7 / 10

**Porte-canon**  
**15421-RP / 15320-RP**

**Entrainement canon tournant**  
**15443-RP**

**Broche / contre-broche**  
**21245-RP / 15370-RP**

**Porte-outils divers**  
**21513-RP/15442-RP/.../15400-RP**

## N° PIÈCE TORNOS / RÉVISION DST

305004 / 305067

305012

305001 / 305063

305006 / 305009 / 305066 / 305102 /  
305143 / 305092 / 305096 / 305115

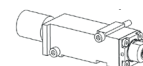
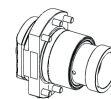

## DECO13

**Canon**  
**15438-RP / 15428-RP**

**Broche / Contre-broche hydraulique.**  
**15375-RP**

**Broche / Contre-broche pneumatique.**  
**13414-RP / 1735**

**Entrainement canon tournant**  
**15418-RP**

**Porte-outils divers**  
**21454-RP / 15001-RP / 15417-RP**

## N° PIÈCE TORNOS / RÉVISION DST

307023 / 307591

Hydraulique 307541  
Pneumatique 307349 / 307348

307135

307056 / 307087 / 305056 / 307085 /  
307055

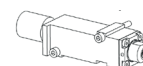
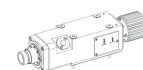
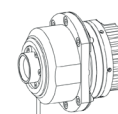

## DECO20

**Porte-canon**  
**..... / 21649-RP / 15372-RP**

**Broche / Contre-broche**  
**15398-RP**

**Porte-outils divers**  
**15466-RP/21650-RP/15424-RP/ ....**  
**/21619-RP**

## N° PIÈCE TORNOS / RÉVISION DST

306078 / 306028 / 306158

306004

306159 / 306164 / 306071 / 306083 /  
306101 /

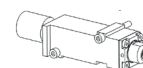
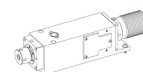

## ENC75

**Broche / Contre-broche**  
**..... / 15324-RP / .....**

**Porte-canon**  
**21651-RP**

## N° PIÈCE TORNOS / RÉVISION DST

109705 / 109312 / 109314

109641

